

BOLD and BRILLIANT. Say YES to YAWAL USA



PANO

WINDOW WITH THERMAL INSULATION

HIGH PERFORMANCE WINDOWS AND DOORS FEATURING BEST IN CLASS QUALITY, TECHNOLOGY, ENERGY EFFICIENCY AND CONTEMPORARY DESIGN

### Say YES to the YAWAL USA PANO WINDOW

The PANO WINDOW is the ultimate energy efficiency solution for your advanced window application. This beautiful and intelligent design features thermal insulators that drive performance to peak levels and includes limitless options including a stunning wood clad aluminum appearance.

The PANO WINDOW also promotes a superior occupant comfort benefit thanks to the capability of offering some of the largest openings (10 feet high for operable and unlimited for fixed) available on the market today - natural light at its peak! Plus this window can be utilized in a passive building or net-zero application as well.

Years of experience and engineering has resulted in a window with excellent acoustic performance as well as air and water protection tested to the most stringent of codes and standards.



## PANO WINDOW SIGNIFICANT BENEFITS

<b>+</b> SUPERIOR U-Value range of 0.12-0.25	<b>+</b> More natural light, oversize/jumbo capability
<b>+</b> Will reduce building energy costs	<b>+</b> A Sustainable Choice - Environmentally Focused
<b>+</b> Meets and EXCEEDS the most rigorous energy codes and guidelines	<b>+</b> Fully Tested & Warranted
<b>+</b> Endless Design Options, incl. Custom Frame Finishes, Glass Choices, Shapes and Sizes	<b>+</b> EASY to order, procure and install!

### CONFIGURATION POSSIBILITIES:

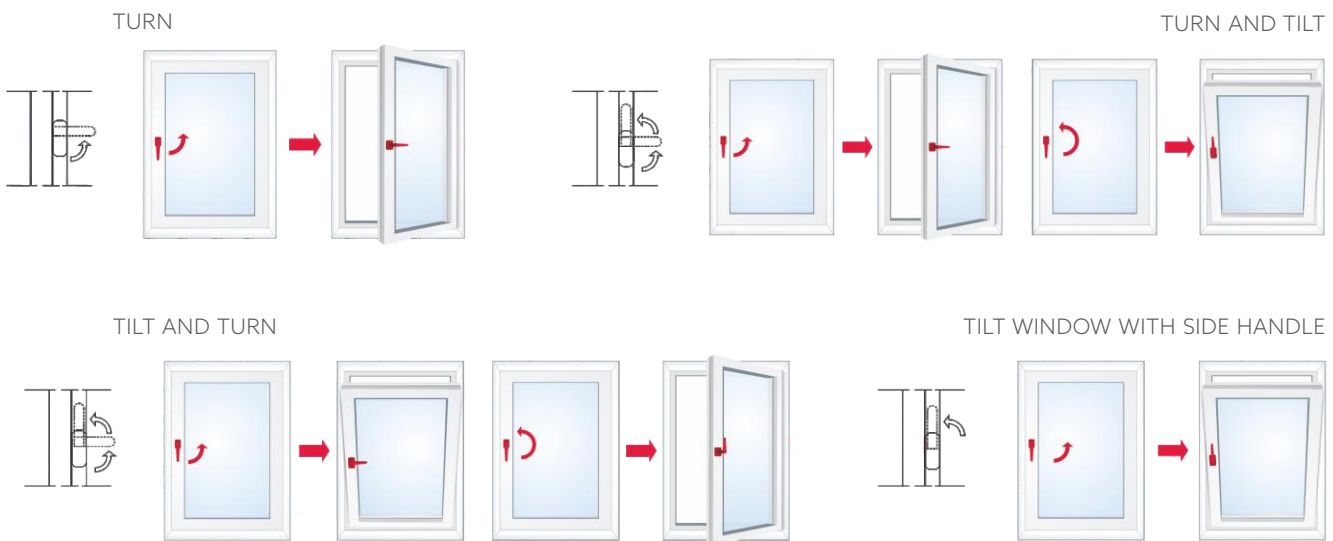

### TECHNICAL SPECIFICATIONS - PANO WINDOW

U-Value	0.12-0.25
Acoustic insulation	STC 39-48 dB
Water tightness	15 psf
Design pressure	PG 65
SHGC	0.20-0.48

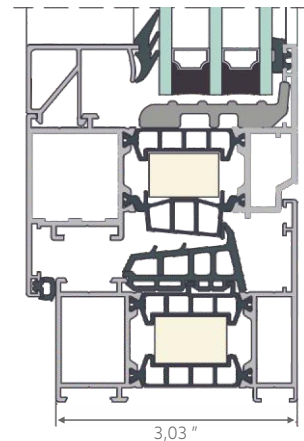

SECTION OF THE PANO WINDOW

### Why it is a Yes to Yawal USA?

**Product** - Windows and Doors designed to meet the needs and desires of contemporary marketplace.

**Performance** - A clear leader in thermal performance, along with a functional and intelligent design that is very attractive for the end user.

**Technology** - European innovation with advanced solutions on thermal, acoustic, health and safety.

**Reliability** - Durable, tested, warranted and a 30+ year track record.

**Design** - Bold and Brilliant. Slim frames, smart hinges, wider oversize spans, built for maximum healthy natural light.

**Our World** - Environmentally focused, sustainable product manufactured by a company committed to true social responsibility.