







Yawal USA Design and Architecture Guide

BOLD AND BRILLIANT
WINDOWS AND DOORS



CONTENTS

About us	3
Production and logistics	4
Products	4
Quality and environment	4
Certificates	5
Customer Service	6
Software	7
AIA CEU	7
YAWAL SYSTEMS	
 SYSTEMS OF SLIDING AND LIFT AND SLIDING DOORS	8-13
Moreview	8-9
Pano Lift'N'Slide	10-11
Scenic Slider	12-13
Configurations options of Moreview, Pano Lift'N'Slide and Scenic Slider Systems	14-15
 WINDOW & DOOR SYSTEMS WITH THERMAL INSULATION	16-27
Passive	16-17
Pano	18-19
Scenic	20-21
Configurations options of Pano and Scenic Systems	22-23
Industrial	24-25
Casement	26-27
 PANEL DOOR SYSTEM	28-31
Pano Prestige	28-29
Panel door patterns	30-31
 FACADE SYSTEMS	32-37
FA 50 DesignLine	32-33
FA 50 SmoothLine	34-35
FA 50 VentLine	36-37
 WINDOW & DOOR SYSTEMS WITHOUT THERMAL INSULATION	38-39
Office	38-39
 SPECIAL SYSTEMS	40-41
Yawal Sun Shades	40-41
Colors	42-43

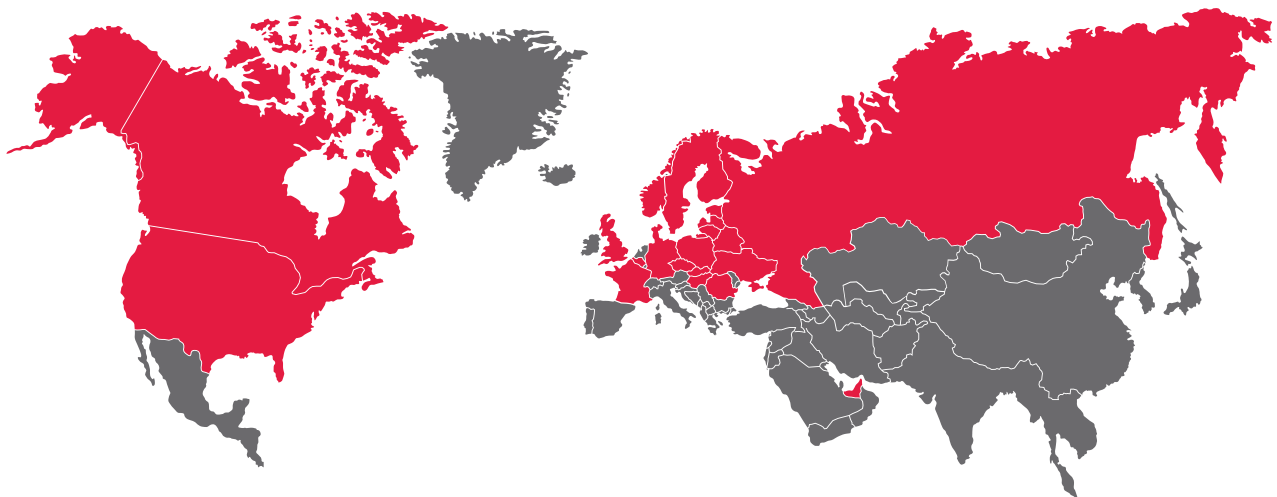
ABOUT US

Founded in 1990 Yawal has always been driven to make the world a more beautiful and safe place. We have built a modern and dynamic company, operating on the European market with an expansion into North America. The experience gathered during 30 years of Yawal's existence and the wide range of innovative solutions we offer, place us among the top suppliers of aluminum architectural systems in the world.

Yawal specializes in designing, marketing and distribution of aluminum systems (Windows, doors, sliding doors, curtain wall and more) as well as in powder coating and bending of profiles.

The main headquarters of Yawal is located in Herby near Częstochowa, Poland. The United States operation is based in New Jersey and sells throughout North America via company sales people, manufacturers representatives and a network of certified dealers. Yawal continues to grow and evolve. In the last few years we have completed several investments that increased our production capabilities and overall efficiencies. Yawal will continue to innovate and lead and our desire to make the world better will not decrease.

 Yawal business scope



SOLUTIONS CUSTOMIZED TO EXPECTATIONS

Architecture of the second half of 21st Century is characterized by variability of forms and its original character. This effect is obtained, amongst others, thanks to the use of various materials, and to the always-continuing creativity of architecture community. However, such spectacular results could not be possible without adequate technology.

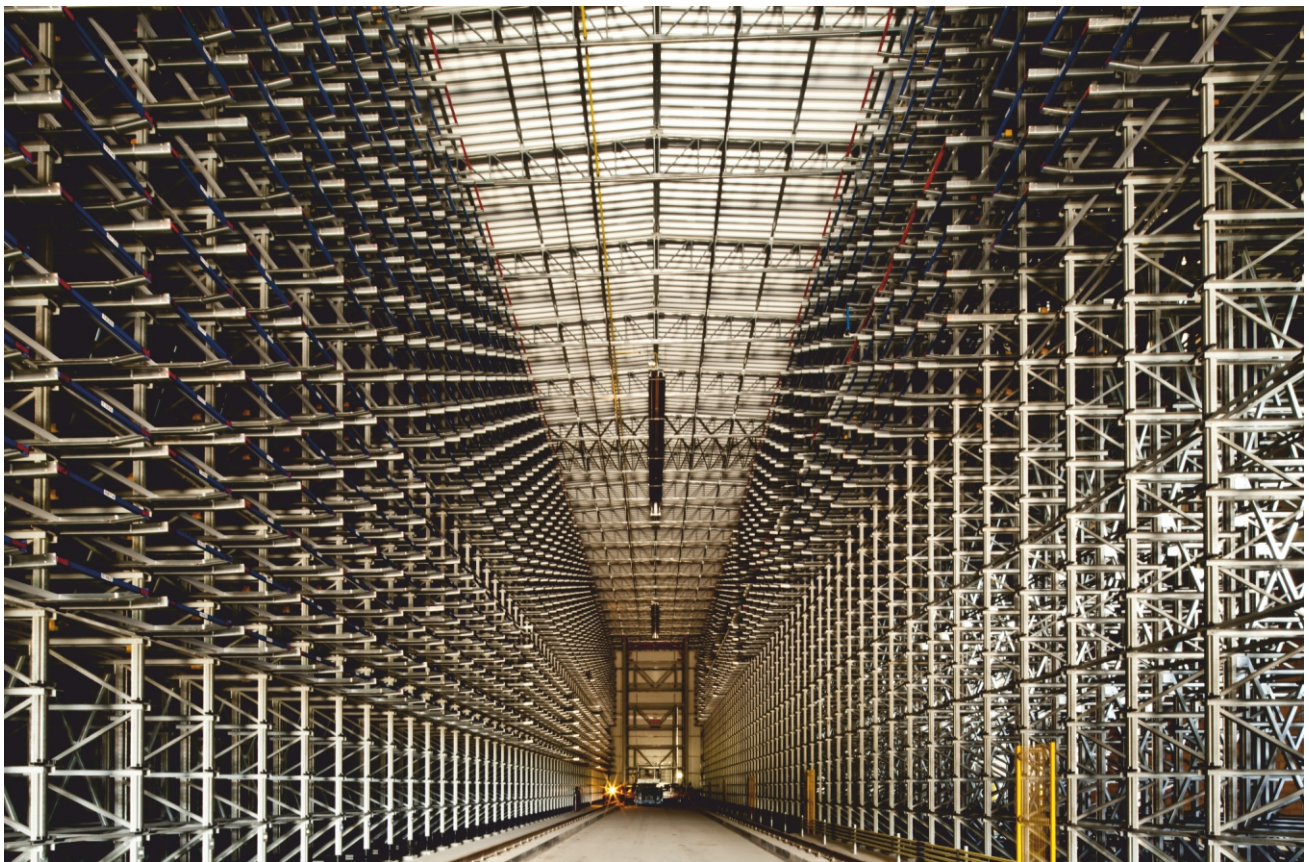
During the quarter-century of business activity, Yawal S.A., cooperating with architects and contractors, has developed customized, unique construction solutions, which make the buildings using Yawal amazingly effective and responsive to clients needs. The end result is high performance, superior quality products that can be used smartly in a multitude of applications.

PRODUCTION AND LOGISTICS

In order to ensure top quality of our products, we are continuously modernizing and expanding our operations. The state of the art operation at Yawal includes the most advanced extrusion presses for aluminum profiles, one of largest anodizing shops in Europe, and one of the most innovative powder coating shops around.

Our focus is on-time deliveries and top quality customer service. To improve our logistics and make it more efficient, we have built a modern high-stock warehouse. We also keep a consistent supply of our standard profiles to additionally shorten the delivery times.

Our Customer Service team is available to all our customers and partners to support all product and information needs.



PRODUCTS

Yawal boasts a vast product line all with keeping the environment in mind. We design and manufacture products for many possible applications including facades, doors, (both entrance and sliding) windows, roofs and skylights. We employ a team of top designers and engineers, who continuously work on new, innovative solutions, with improved performance. Such solutions enable owners and architects to create more intricate and impressive projects.

Our systems of aluminum profiles represent modern technologies that increase energy efficiency, smartly block out any noise due to excellent acoustics, decrease maintenance costs and, last but not least, decrease the assembly time. All Yawal products are seamlessly aligned with smart home solutions.



QUALITY AND ENVIRONMENT

A main objective of Yawal is continuous improvement with regards to quality while also paying close attention to sustainability. We believe quality and smart environmental practices can go hand-in-hand and we will never lower our expectations with either approach.

To meet our goals, we use appropriate materials and manufacture through consecutive stages of production and distribution. From an environmental approach we have made significant investments, including a safe spraying installation, using chrome-free preparations in aluminum chemical treatment. In addition, please note that aluminum is 100% recyclable material. We believe in continuous education of our workforce and it positions Yawal as a workplace that attracts top engineering talent among women and men.

CERTIFICATES

We are an ISO certified organization and follow exact processes as laid out in our certification. Yawal tests all materials to the proper codes and standards including those from AAMA and NFRC. We also have strict internal performance measures that consistently keep our focus on quality. The technical parameters of the products in this Guide are for guidance purposes only and please refer to technical certifications for the exact values. Technical parameters depend on size and type of each structure/frame.

One approach is our Quality Management System that complies with ISO standards, and is confirmed with a certificate issued by BSI for: designing, production and distribution of aluminum profiles and architectural aluminum systems for building industry, and corresponding technical assistance.

The second approach is our Environmental Management System ISO 14001:2004, confirmed with a certificate issued by BSI (a certification body).

Yawal meets all legal requirements specified by those certificates, maintains a policy of rational utilization of media, materials and raw materials, and uses effective devices to minimize negative influence on the environment. As far as powder coating is concerned, Yawal obtained a QUALICOAT license, including Seaside, of the Association for Quality Control in the Lacquering, Painting and Coating Industry.

CUSTOMER SERVICE

Yawal is dedicated to providing the best in customer service. This is a basic look at the process that we take every day to support your needs. Our website has detailed information and our sales teams welcome your questions too!

If you reach out to us with a project, within 3 days we'll provide you a detailed quote and value proposition. We will then go through a process of review, changes, updates, and add-ons etc.

Once that is settled production begins, shipping and delivery details will be provided along with order acknowledgments.

In the plant your material is carefully produced at the highest level of quality, then packaged safely for shipment to you. Yawal will then use the most reliable shipping methods and partners to get it from our door to yours. We will make sure you are more than satisfied with your order and experience with us and look forward to our next project together.

Customer assistance includes:

- Technical advice by our specialists both in the field and at Yawal offices
- Training on technical solutions, calculations and material bills for customers (This can be done either in Poland or at your place of operation by our local sales team)
- Design assist and support, including CAD drawings
- Structural analysis and price calculations for projects
- Collaboration on designing complicated aluminum structures and technical supervision
- Technical assistance for our software, Yawal Constructor & Yawal Pro



Yawal USA team: **Adam Lisek** - Logistics Specialist, **Justyna Gonera** - Senior Technical Specialist, **Daniel Kuna** - Country Manager, **Rafał Włodzik** - Senior Technical Advisor, **Kamila Jarosz** - Project Manager & Customer support, **Piotr Bajor** - Marketing Specialist, **Izabela Minda** - Architect Advisor.

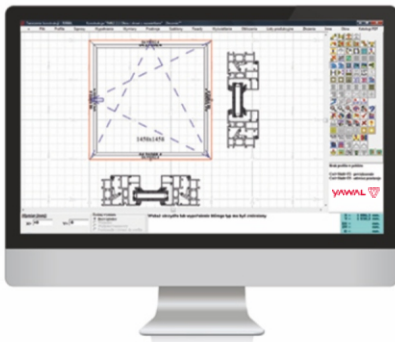
SOFTWARE

In order to make design and take-offs easier for our customers, we offer dedicated software to support the complete production process.

Yawal Constructor is a specialist software developed to prepare offers quickly, generate material bills, creating production lists and cutting lists. It also allows for exporting the frame of created structures to CAD type software and to export data to Excel.

Yawal Pro is supplied by Orgadata. This application is integrated with functions for the financial and accounting departments. Orgadata is in constant contact with our support team to make sure that the database is always updated with new products.

Both, Yawal Constructor and Yawal Pro facilitate preparing data for control systems of machines for fabrication and production.



Yawal Constructor
Construction designing window



Yawal Constructor
Example of offer window



Yawal PRO
Example of CNC processing window

AIA CEU

Yawal believes in education and growth. We are pleased to offer several different educational opportunities including Continuing Education Unit offerings via the American Institute of Architects (AIA). Our goal is to always have fresh offerings on new trends and important code and guideline issues that affect the building product industry. We employ several professionals who are certified to present these courses and also help craft the messaging and details.

For more information or specific details on the forms of education we offer please contact us.





The MOREVIEW sliding door system features an extremely minimal frame, while offering significantly more view. It is available in industry leading sizes up to 16 feet, but its architecture is truly light and subtle.

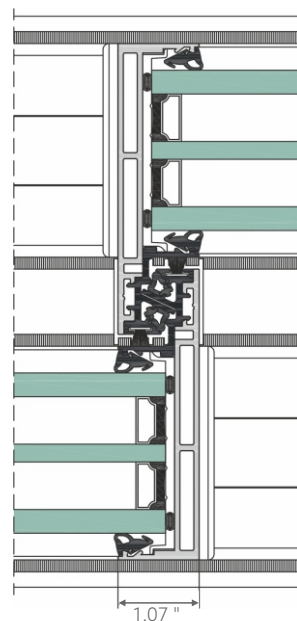
MOREVIEW allows for hiding the aluminum frame of the structure in the floor, walls and the ceiling, thus the boundary between the house interior and the outside surrounding is blurred.

ADVANTAGES OF THE SYSTEM

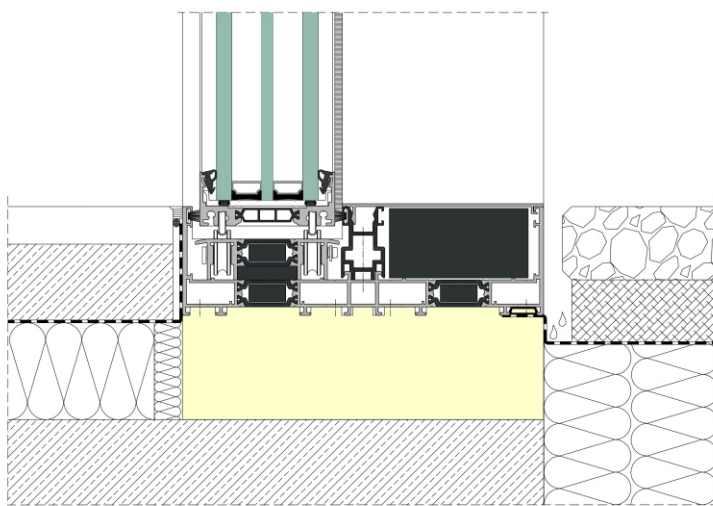
- Oversize System - Available in Sizes up to 16 feet
- Superior Visible Light Transmittance - Minimal Framing
- More than 30 Color and Finish Options Available
- Unlimited Construction Possibilities

Photo: Example of system use



CROSS-SECTION OF
LEAF CONNECTION
MOREVIEW

CROSS SECTION OF THE DOOR FRAME MOREVIEW



TECHNICAL PARAMETERS - MOREVIEW

Air tightness	A3
Water tightness	7.5 psf
Designed pressure	LC 50 psf
U-Value	0.12 Btu/hft ² F
Forced entry resistance	RC2
Acoustic insulation	STC = 42 dB

SYSTEM CHARACTERISTICS

Maximum weight of manually operated sliding sash	880 lbs (400 kg)
Maximum weight of automatically operated sliding sash	2640 lbs (1200 kg)
Maximum weight of fixed sash	2200 lbs (1000 kg)
Maximum height of construction	16 ft (5 m)
Maximum width of construction	13 ft (4 m)
Glass thickness	1.97 - 2.36 " (50-60 mm)
Construction depth for double-rail guide	7.56 " (192 mm)
Construction depth for triple-rail guide	11.57 " (294 mm)
Construction depth for sash	2.83 " (72 mm)
Visible width of interlock	1.06 " (27 mm)

PANO LIFT'N'SLIDE SYSTEM OF LIFT AND SLIDING DOORS

EXCELLENT THERMAL INSULATION

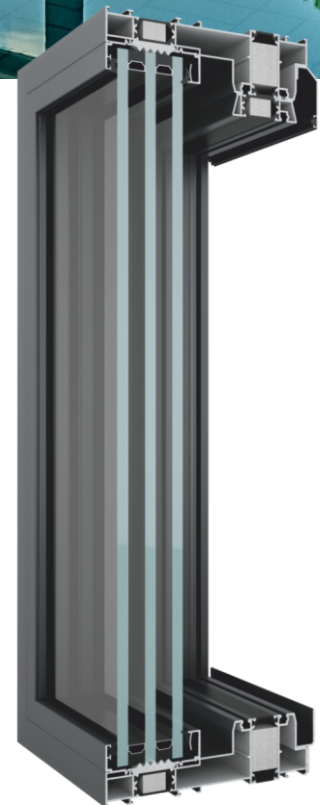


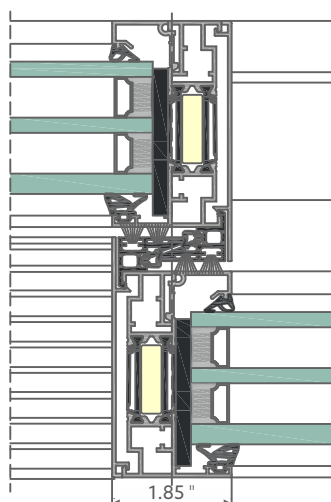
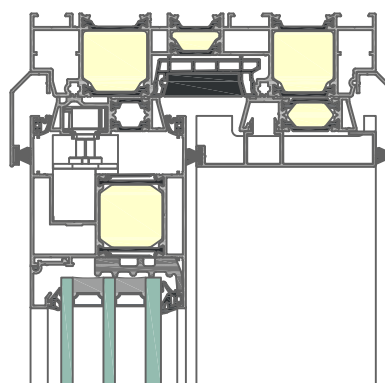
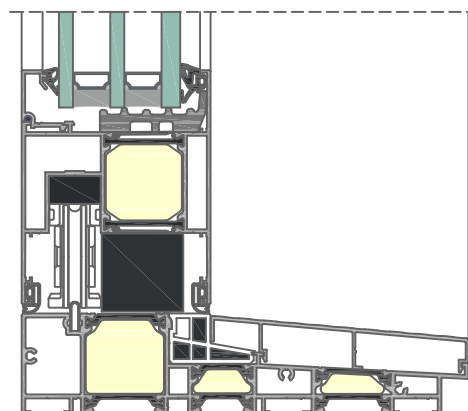
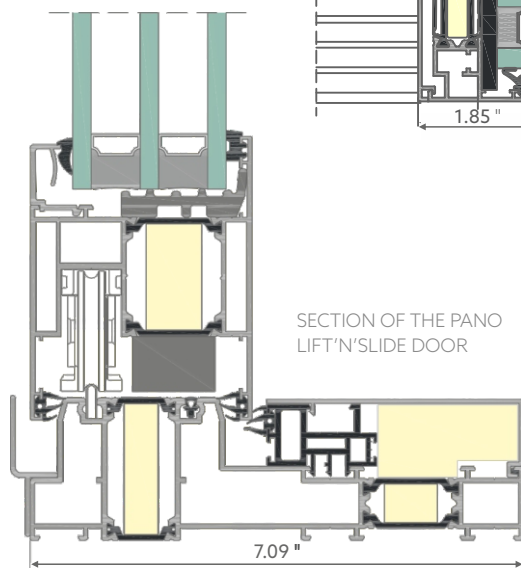
PANO LIFT'N'SLIDE is a design without boundaries that allows multiple options including a real wood look from an aluminum product, motorized & wireless opening, and a threshold free design.

ADVANTAGES OF THE SYSTEM

- SUPERIOR U-Value range of 0.12-0.25
- OVERSIZE capability - up to 11 feet high and 11 feet wide-more natural light, wide spans = great view
- Automatic opening and closing systems including Bluetooth, eye scanning & fingerprint options
- Custom Frame Finish including Realistic Wood Design

Photo: Single - family house



SECTION OF THE LEAF
CONNECTION

SECTION OF THE PANO LIFT'N'SLIDE
DOOR WITH AUTOMAT

SECTION OF THE PANO LIFT'N'SLIDE
DOOR - LOW THRESHOLD

SECTION OF THE PANO
LIFT'N'SLIDE DOOR


ASSEMBLY OF AUTOMATIC DOOR OPENING
MECHANISM IS AN ADDITIONAL OPTION

TECHNICAL PARAMETERS - PANO LIFT'N'SLIDE

Air tightness	A3
Water tightness	12 psf
Designed pressure	CW 60 psf
U-Value	0.12-0.25 Btu/hft ² F
Forced entry resistance	RC2
Acoustic insulation	STC = 47 dB

SYSTEM CHARACTERISTICS

Maximum weight of sliding leaf	950 lbs (430 kg)
Maximum height of leaf	11 ft (3300 mm)
Maximum weight of sash	11 ft (3300 mm)
Glass thickness	0.71÷2.44 " (18÷62 mm)
Construction depth for double-rail	7.09 " (180 mm)
Construction depth for triple-rail	10.98 " (279 mm)
Construction depth for sash	3.19 " (81 mm)
Visible width of interlock	1.85 " (47 mm)



The jumbo opening and oversize slider that goes into it is a growing market. The available options allow further performance with customization to meet virtually any design criteria.

The SCENIC SLIDER is available in sizes up to 8 feet high.

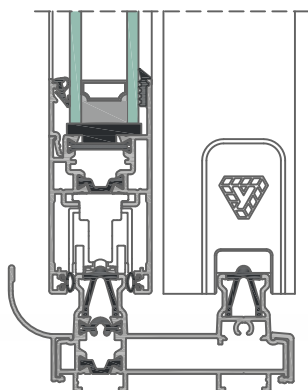
ADVANTAGES OF THE SYSTEM

- SUPERIOR U-Value range from 0.23
- Can utilize double or triple pane insulating glass units for more performance and better acoustics
- Budget Friendly for light commercial projects
- Endless Design Options, incl. Custom Frame Finishes, Glass Choices, Shapes and Sizes

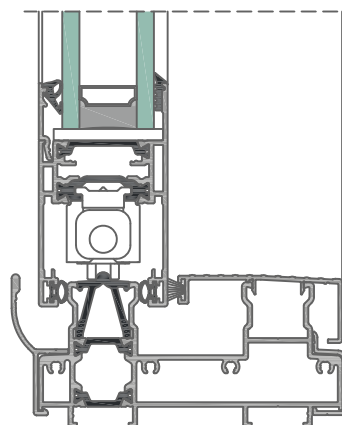
Photo: Example of system use



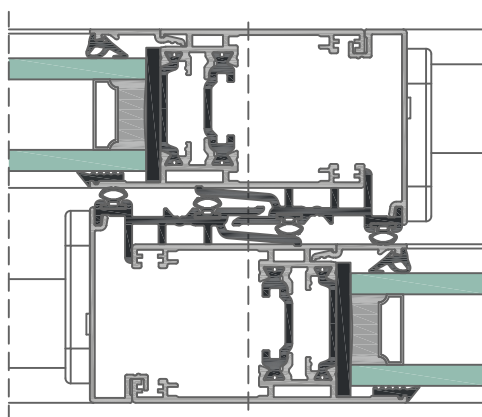
CROSS SECTION OF DOOR THERM



CROSS SECTION OF DOOR THERM+



INTERLOCK CROSS SECTION THERM+



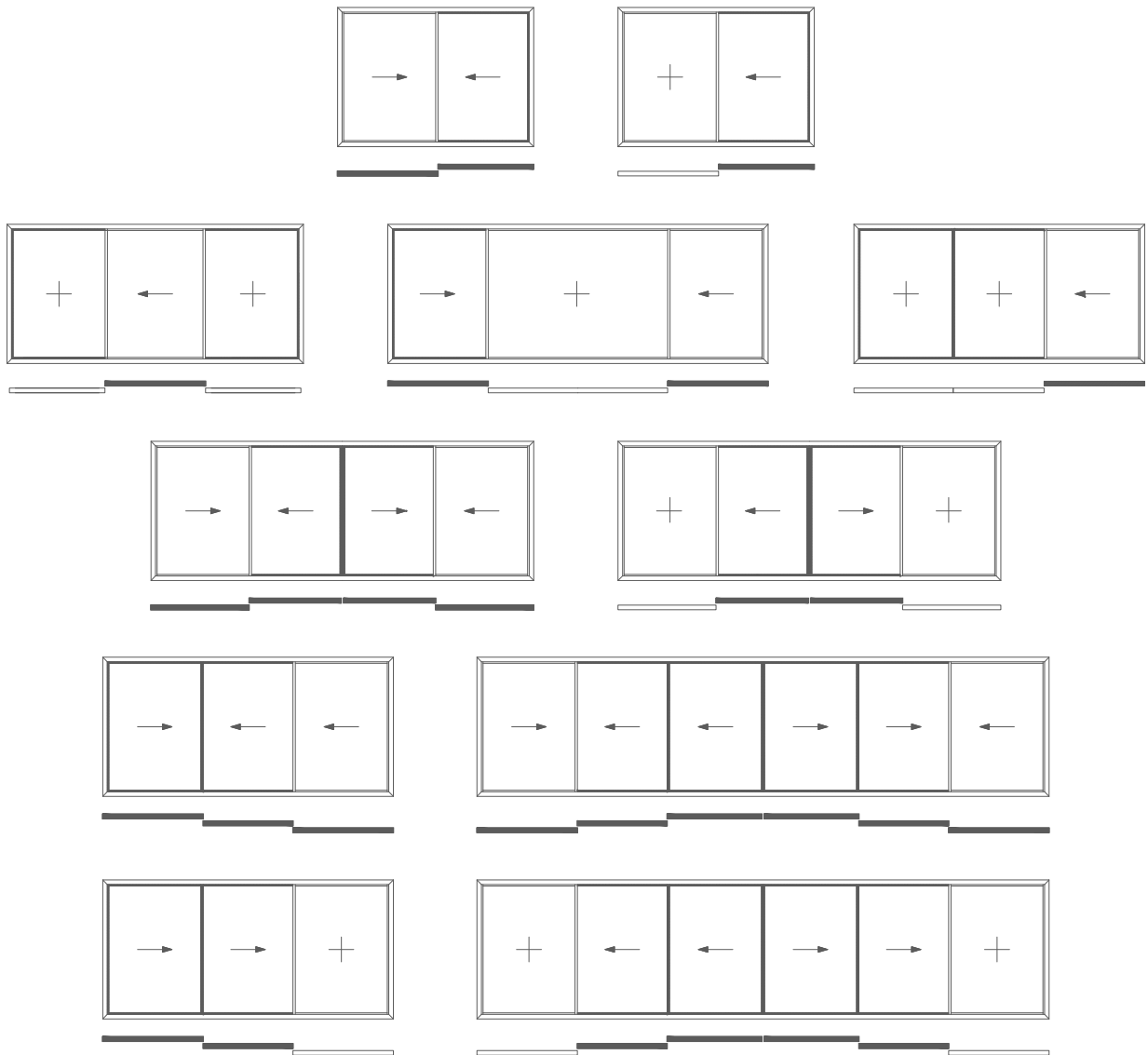
TECHNICAL PARAMETERS - SCENIC SLIDER

	THERM	THERM+
Air tightness	A3	A3
Water tightness	7.5 psf	7.5 psf
Designed pressure	LC 40 psf	LC 50 psf
U-Value	0.27-0.40 Btu/hft ² F	0.23-0.36 Btu/hft ² F
Forced entry resistance	-	-
Acoustic insulation	STC up to 40 dB	STC up to 40 dB

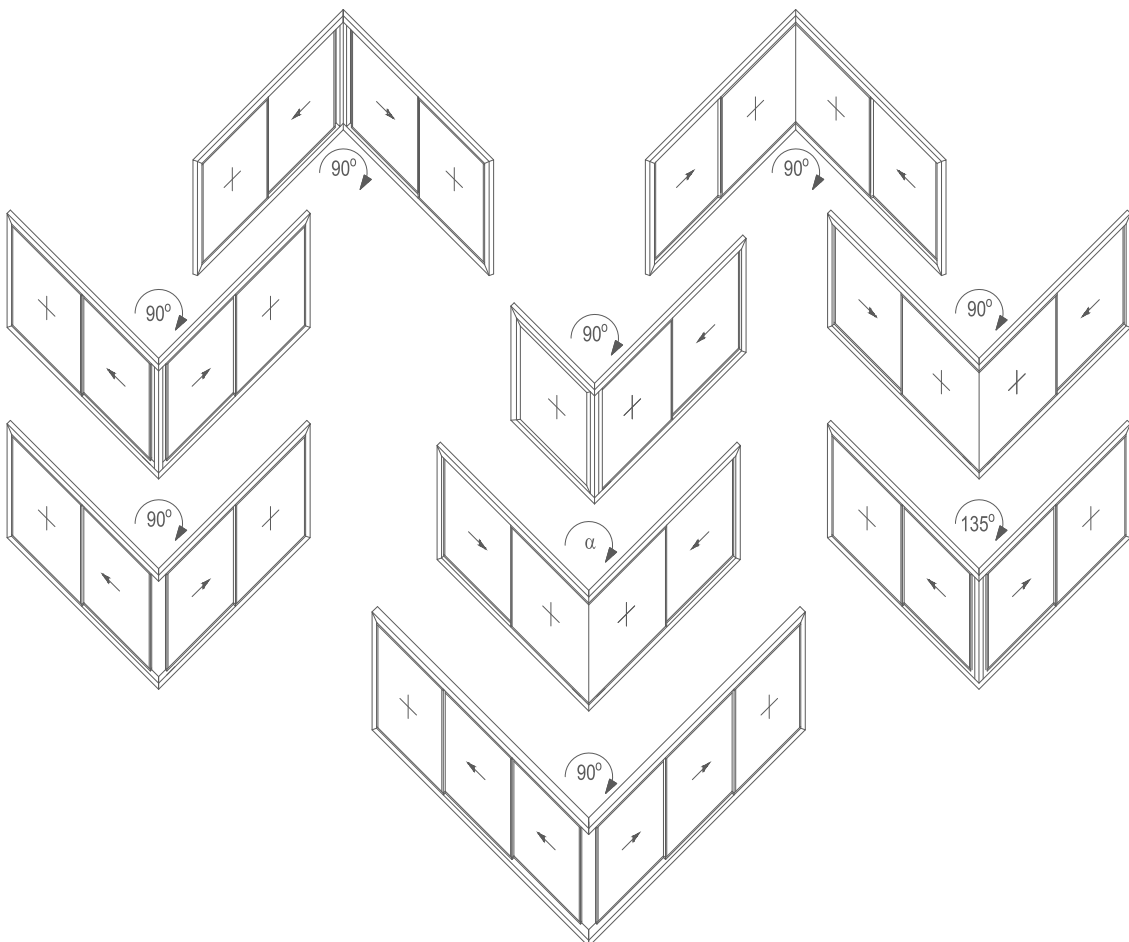
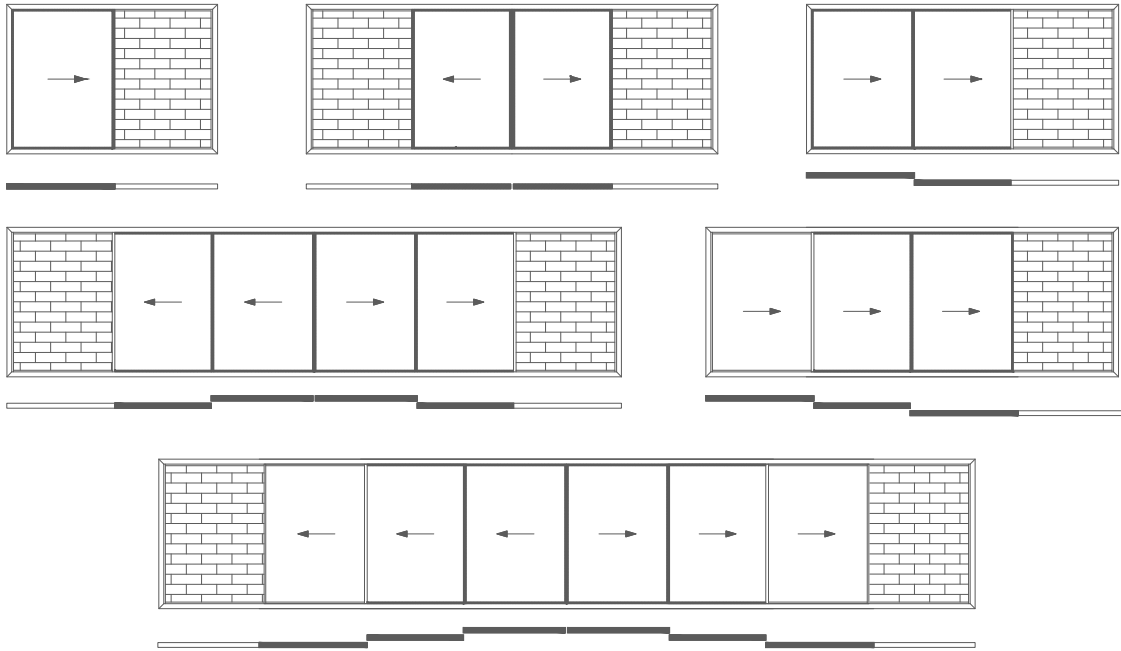
SYSTEM CHARACTERISTICS

	THERM	THERM+
Maximum weight of sliding sash	180 lbs (80 kg)	440 lbs (200 kg)
Maximum weight of lift-and-slide sash	260 lbs (120 kg)	440 lbs (200 kg)
Maximum height of sash	94.49 " (2400 mm)	94.49 " (2400 mm)
Maximum width of sash	47.24 " (1200 mm)	47.24 " (1200 mm)
Glass thickness	0.79 - 0.94 " (20-24mm)	1.14 - 1.30 " (29-33 mm)
Construction depth for double-rail	3.39 " (86 mm)	4.25 " (108 mm)
Construction depth for triple-rail	-	6.57 " (167 mm)
Construction depth for sash	1.42 " (36 mm)	1.77 " (45 mm)
Visible width of interlock	3.23 " (82 mm)	1.77 " (45mm)

CONFIGURATION OPTIONS OF MOREVIEW, PANO LIFT'N'SLIDE AND SCENIC SLIDER SYSTEMS



CONFIGURATION OPTIONS OF MOREVIEW AND PANO LIFT'N'SLIDE SYSTEMS





YAWAL PASSIVE System is dedicated to "Net Zero" and passive in both commercial and residential buildings. It has the ability to be utilized in oversize and heavy duty applications.

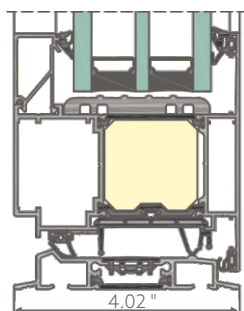
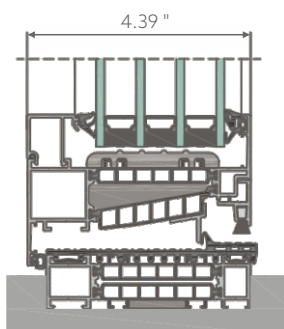
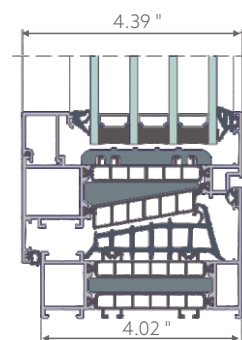
The high performance glass options are for double as well as triple glazing options.

ADVANTAGES OF THE SYSTEM

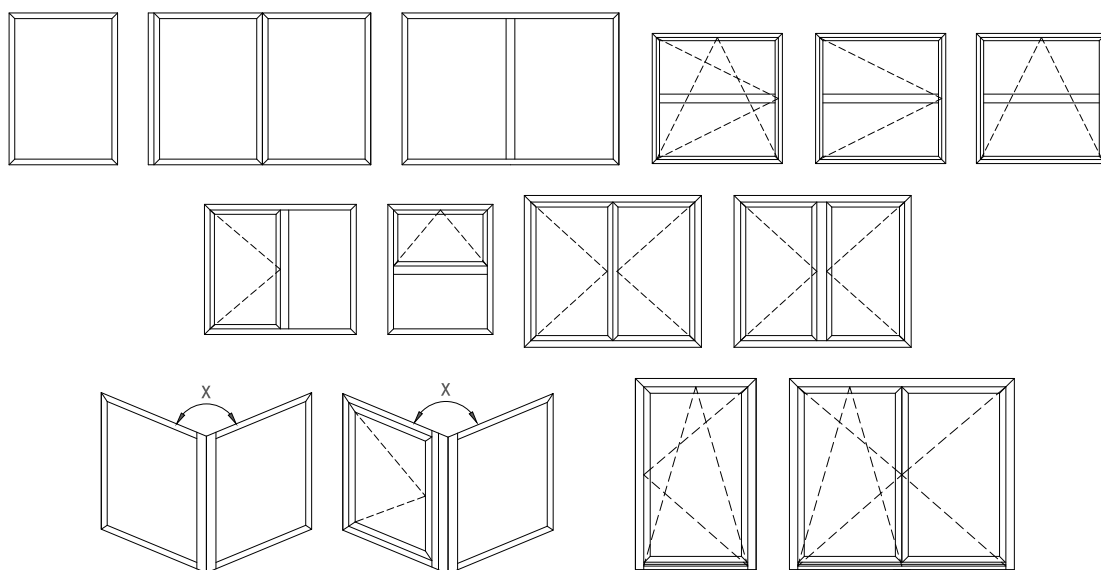
- Highest thermal performance, with U factor below
- Oversize and heavy duty application ready
- Superior water-tightness due to innovative central seal construction
- Modern design of lock profiles in combination with the new gaskets allows for creating one uninterrupted and surface of aluminum and gaskets
- Oversize and heavy duty application ready

Photo: Kindergarten nr 10, Mysłowice / Design: Usługi Projektowe Paweł Drabik
Aluminium manufacturer: For-Bud, Krzepice



CROSS SECTION OF
DOOR THRESHOLD

CROSS SECTION OF LOW
THRESHOLD WINDOW PASSIVE

CROSS SECTION OF
WINDOW PASSIVE


CONFIGURATION OPTIONS OF PASSIVE SYSTEM



TECHNICAL PARAMETERS - PASSIVE

Air tightness	A3
Water tightness	15 psf
Designed pressure	AW 75 psf
U-Value	from 0.08 Btu/hft ² F
Forced entry resistance	RC2
Acoustic insulation	STC 39÷48 dB

SYSTEM CHARACTERISTICS

Structural depth	Frame profile	4.02 " (102 mm)
	Sash profile	4.39 " (111.4 mm)
Thickness of infills	Frame profile	1.38÷2.72 " (35÷69 mm)
	Sash profile	1.73÷2.83 " (44÷72 mm)
Maximum sash/vent dimensions	Width	6 ft (1600 mm)
	Height	10 ft (3000 mm)
Maximum sash/vent weight		60 lbs (300 kg)



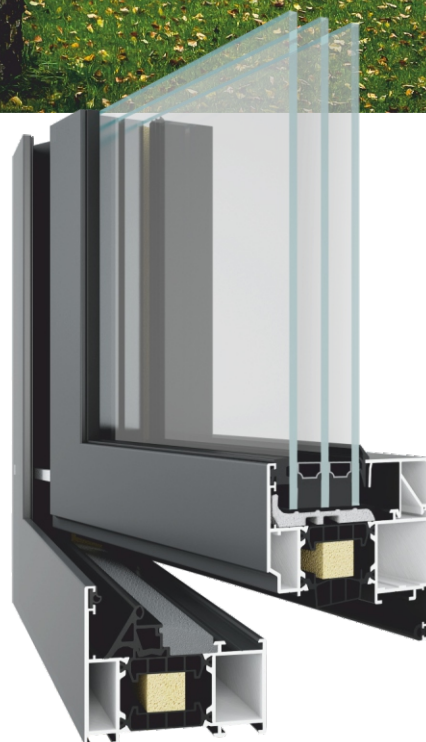
The PANO WINDOW promotes a superior occupant comfort benefit thanks to the capability of offering some of the largest openings (10 feet high for operable and unlimited for fixed) available on the market today - natural light at its peak!

Plus this window can be utilized in a passive building or net-zero application as well.

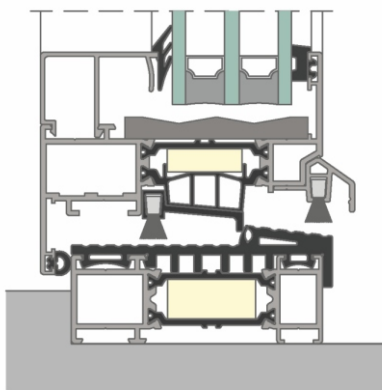
ADVANTAGES OF THE SYSTEM

- SUPERIOR U-Value range of 0.12-0.25
- More natural light, oversize/jumbo capability
- Endless Design Options, incl. Custom Frame Finishes, Glass Choices, Shapes and Sizes

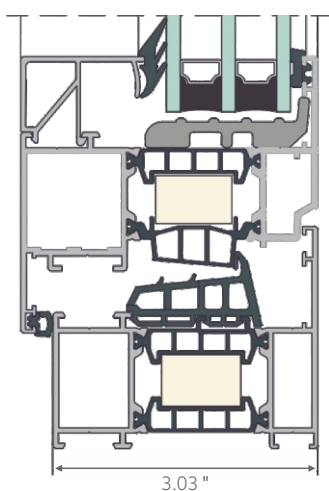
Photo: Corner House, Warsaw / Design: Biuro Projektów Kazimierski i Ryba Sp. J., Warsaw
Aluminium manufacturer: BUMA FACTORY, Cracow



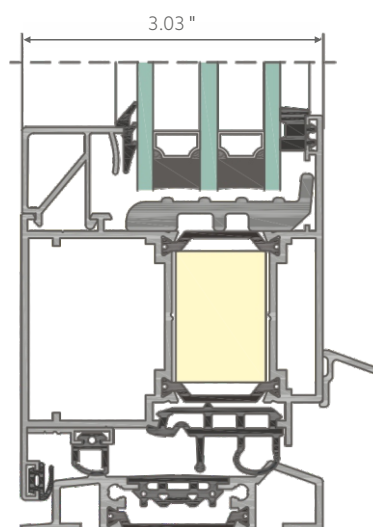
CROSS SECTION OF LOW THRESHOLD WINDOW



CROSS SECTION OF PANO WINDOW



CROSS SECTION OF DOOR THRESHOLD



TECHNICAL PARAMETERS - PANO

	PANO WINDOW	PANO GLASS DOOR
Air tightness	A3	A3
Water tightness	15 psf	7,5 psf
Designed pressure	AW 65 psf	CW 55 psf
U-Value	0.12÷0.25 Btu/hft ² F	0.16÷0.26 Btu/hft ² F
Forced entry resistance	RC2, RC3, RC4	RC2, RC3
Acoustic insulation	STC = 39÷48 dB	STC = 36÷45 dB

SYSTEM CHARACTERISTICS

Window structural depth	Frame profile	3.03" (77 mm)
	Sash profile	3.40 " (86.4 mm)
Door structural depth	Frame profile	3.03 " (77 mm)
	Sash profile	3.03 " (77 mm)
Glass pane thickness for windows	Frame profile	0.75÷2.40 " (19÷61 mm)
	Sash profile	1.10÷2.64 " (28÷67 mm)



The SCENIC is a modern window system that is perfect for many applications including both new construction and retrofit.

The operable SCENIC is available in sizes up to 10 feet high, while the fixed version is unlimited by size restrictions.

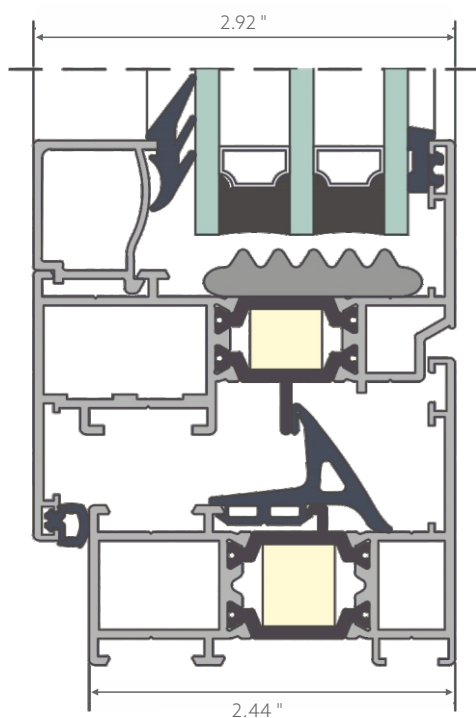
ADVANTAGES OF THE SYSTEM

- SUPERIOR U-Value range of 0.17-0.31
- Narrow siteline allowing more of the view
- Budget Friendly for light commercial projects
- Endless Design Options, incl. Custom Frame Finishes, Glass Choices, Shapes and Sizes

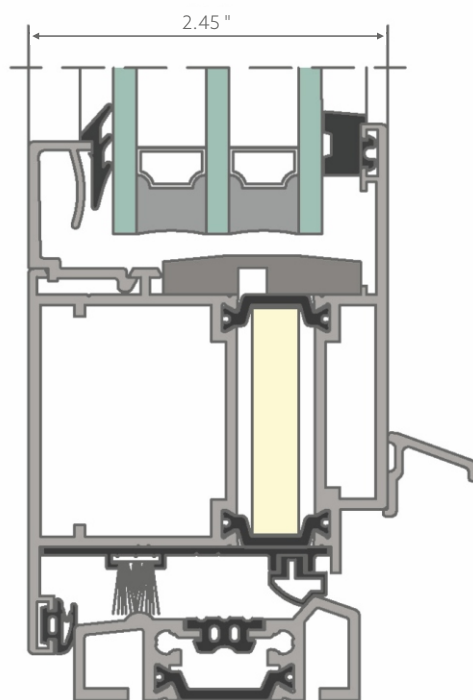
Photo: Residential Estate Galeria Park, Warsaw / Design: KAPS Architekci, Warsaw
Aluminium manufacturer: MBB, Toruń



CROSS SECTION OF WINDOW



CROSS SECTION OF DOOR WITH THRESHOLD



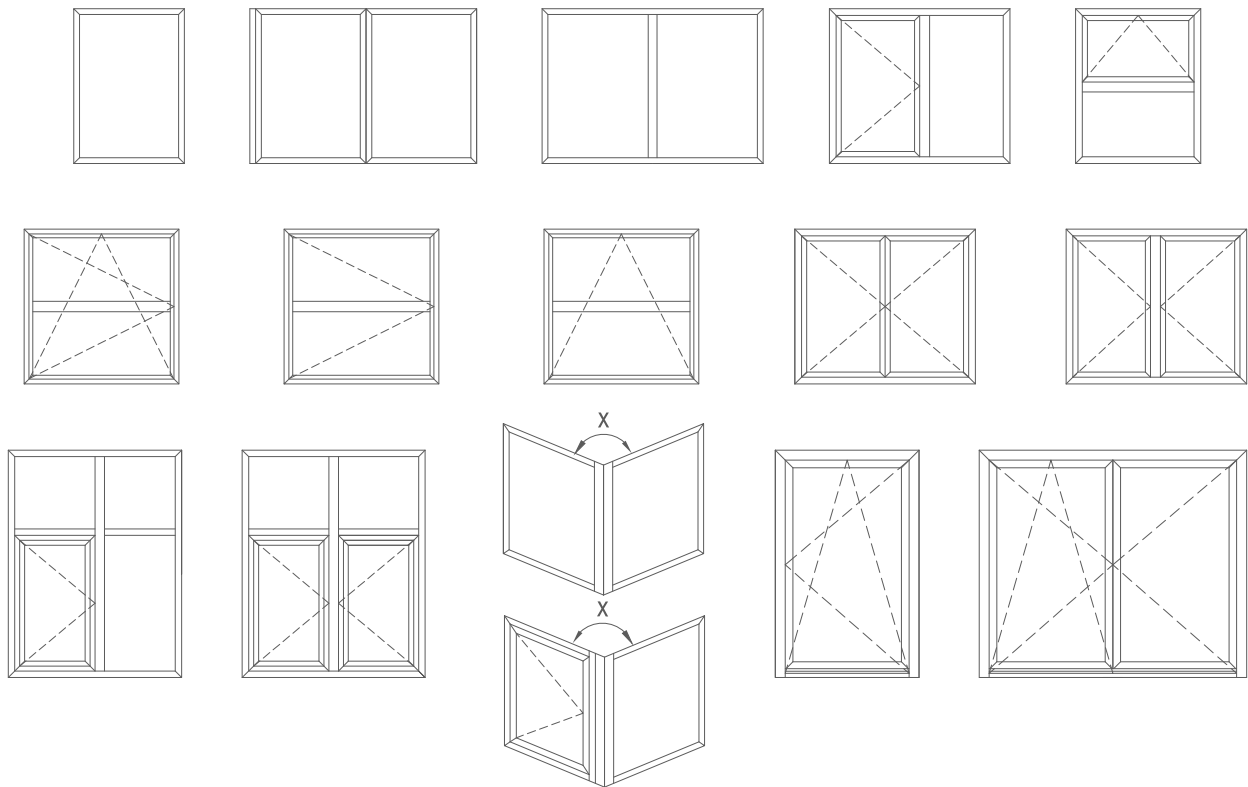
TECHNICAL PARAMETERS - SCENIC

	SCENIC WINDOW	SCENIC GLASS DOOR
Air tightness	A3	A3
Water tightness	15 psf	7.5 psf
Designed pressure	AW 65 psf	CW 55 psf
U-Value	0.17-0.31 Btu/hft ² F	0.23÷0.43 Btu/hft ² F
Forced entry resistance	RC2, RC3	RC2, RC3
Acoustic insulation	STC = 35÷42 dB	STC = 35÷44 dB

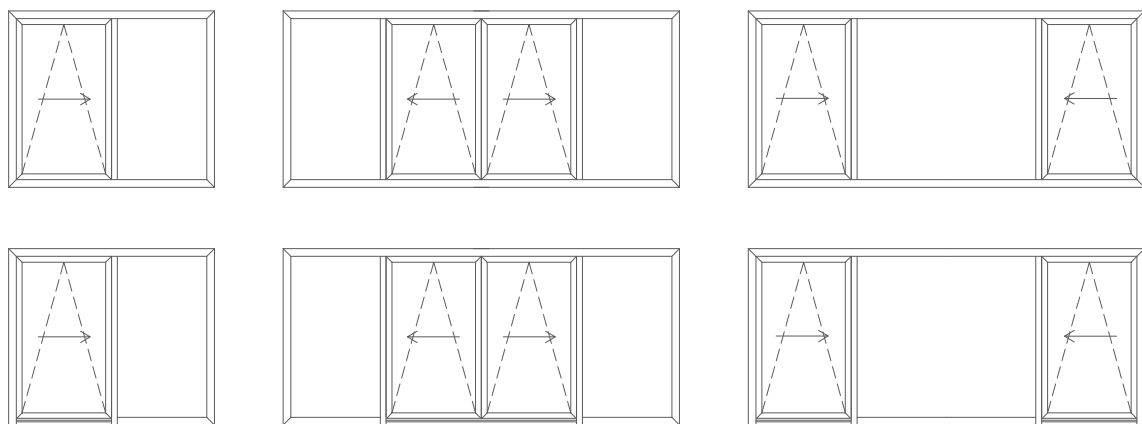
SYSTEM CHARACTERISTICS

Window structural depth	Frame profile	2.44 " (62 mm)
	Sash profile	2.81 " (71.4 mm)
Door structural depth	Frame profile	2.44 " (62 mm)
	Sash profile	2.44 " (62 mm)
Glass pane thickness for windows	Frame profile	0.65 - 2.15 " (16.5-54.5 mm)
	Sash profile	1.02 - 2.52 " (25.9-63.9 mm)

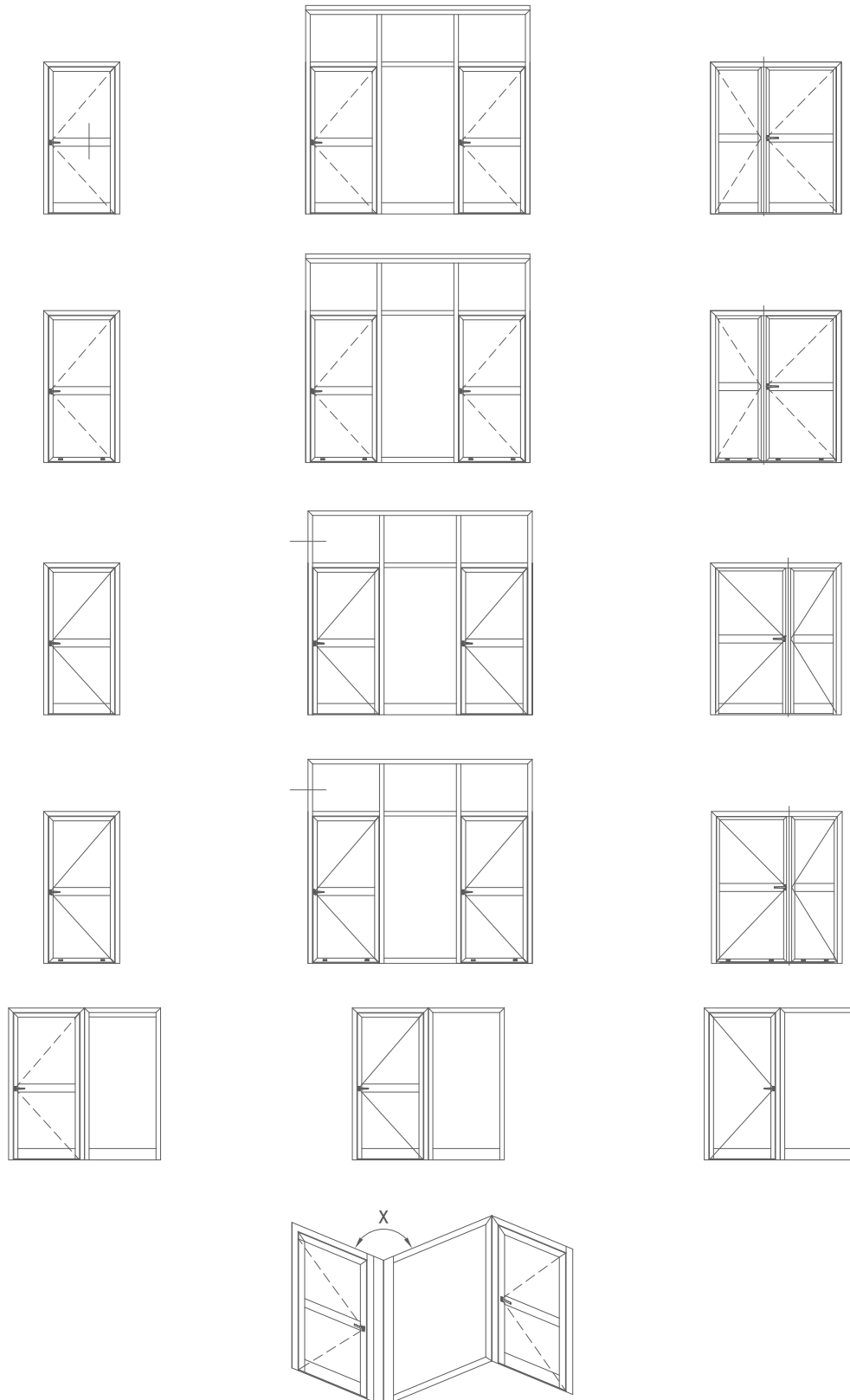
CONFIGURATION OPTIONS OF PANO AND SCENIC SYSTEMS



CONFIGURATION OPTIONS OF PANO AND SCENIC SYSTEMS WITH TILT AND SLIDE



CONFIGURATION OPTIONS OF PANO AND SCENIC SYSTEMS





Imitating classic steel window design with modern solution. This is the perfect solution for steel windows in modernized industrial facilities, apartments, and historical buildings.

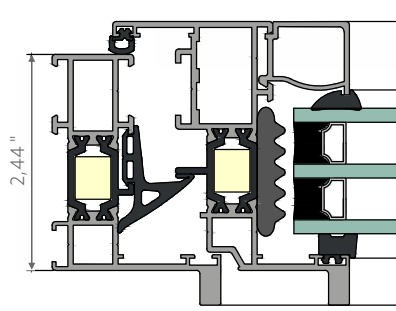
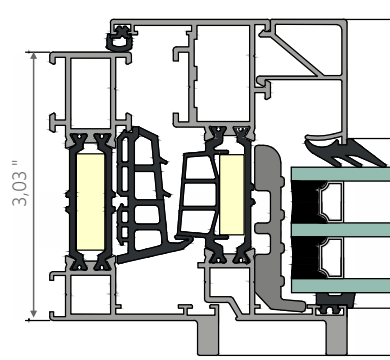
The base of the INDUSTRIAL system features aluminum structural sections with thermal separators and infills of high thermal insulation properties.

ADVANTAGES OF THE SYSTEM

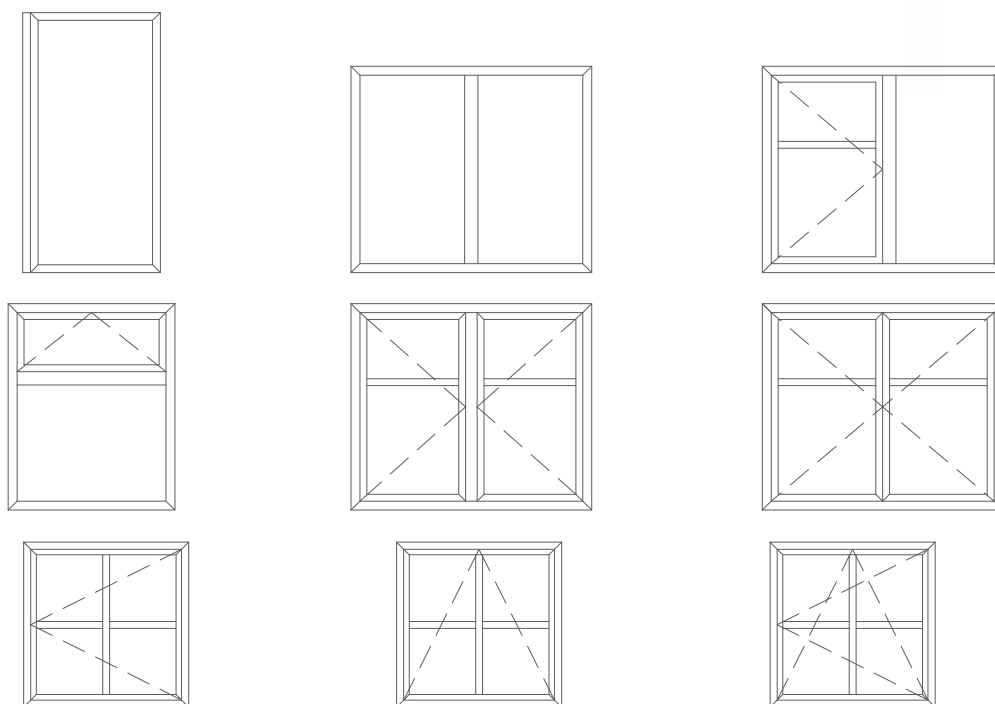
- Integrates perfectly with other Yawal's windows and doors systems
- Excellent Solar Heat Gain Coefficient (SHGC)
- Smart and effective drainage
- Aesthetically pleasing with narrow window sitelines visible from the outside



Photo: Grohman Factory, Łódź / Design: AGG Architekci Grupa Grabowski Sp. z o.o., Łódź
Aluminium manufacturer: OLI Sp. z o.o., Piotrków Trybunalski

CROSS SECTION OF WINDOW
SCENIC INDUSTRIAL

CROSS SECTION OF WINDOW
PANO INDUSTRIAL


CONFIGURATION OPTIONS OF INDUSTRIAL SYSTEM



TECHNICAL PARAMETERS - INDUSTRIAL

	SCENIC INDUSTRIAL	PANO INDUSTRIAL
Air tightness	65 psf	A3
Water tightness	15 psf	15 psf
Designed pressure	AW 65 psf	AW 65 psf
U-Value	0.17-0.31 Btu/hft ² F	0.12÷0.25 Btu/hft ² F
Forced entry resistance	RC2, RC3	RC2, RC3, RC4
Acoustic insulation	STC = 35÷42 dB	STC = 39÷48 dB

SYSTEM CHARACTERISTICS

		SCENIC INDUSTRIAL	PANO INDUSTRIAL
Window structural depth	Frame profile	2.44 " (2.83 ") (62 mm (72 mm))	3.03 " (3.43 ") (77 mm (87 mm))
	Sash profile	2.81 " (3.20 ") (71.4 mm (81.4 mm))	3.40 " (3.80 ") (86.4 mm (96.4 mm))
Glass pane thickness for windows	Frame profile	0.65-2.15 " (16.5-54.5 mm)	0.75÷2.40 " (19÷61 mm)
	Sash profile	1.02 - 2.52 " (25.9-63.9 mm)	1.10÷2.64 " (28÷67 mm)



CASEMENT provides many advantages including ventilation, space saving, and the exterior view being unimpeded.

This system allows the wind load to press the window sash into the frame, ensuring high tightness of the structure.

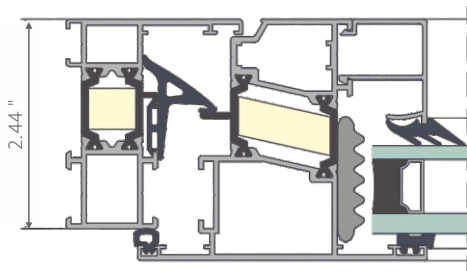
ADVANTAGES OF THE SYSTEM

- Contemporary and smart design
- Excellent air and water performance
- Potential to be integrated in many different design and window system applications

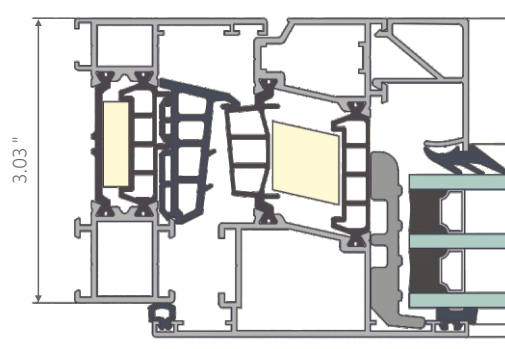


Photo: Primary School no. 3, Ruda Śląska / Design: Salwator & Architekci, Grupa VERSO
Aluminium manufacturer: Domkat Sp. z o.o.

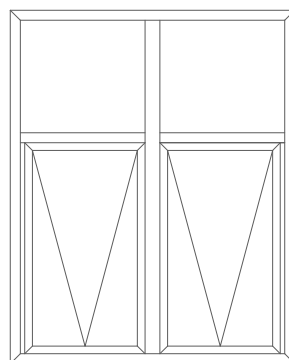
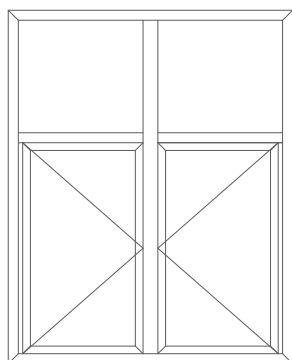
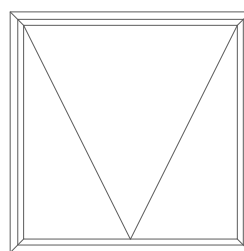
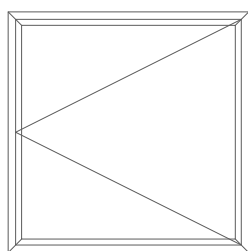
CROSS SECTION OF WINDOW SCENIC CASEMENT



CROSS SECTION OF WINDOW PANO CASEMENT



CONFIGURATION OPTIONS OF CASEMENT SYSTEM



TECHNICAL PARAMETERS - Casement

	SCENIC CASEMENT	PANO CASEMENT
Air tightness	A3	A3
Water tightness	15 psf	15 psf
Designed pressure	AW 55 psf	AW 65 psf
U-Value	0.17-0.31 Btu/hft ² F	Uf = 0.14÷0.25 Btu/hft ² F
Forced entry resistance	RC2, RC3	RC2, RC3, RC4
Acoustic insulation	STC = 35÷42 dB	STC = 39÷48 dB

SYSTEM CHARACTERISTICS

		SCENIC CASEMENT	PANO CASEMENT
Window structural depth	Frame profile	2.44 " (62 mm)	3.03 " (77 mm)
	Sash profile	2.56 " (64.9 mm)	3.15 " (79.9 mm)
Glazing thickness		0.94÷2.04 " (24-52 mm)	1.02÷2.64 " (26-67 mm)
Max. dimension of sash		height: 8 ft width: 4 ft	height: 10 ft width: 5 ft



PRESTIGE is a leader in energy efficiency, keeping HVAC costs in check.

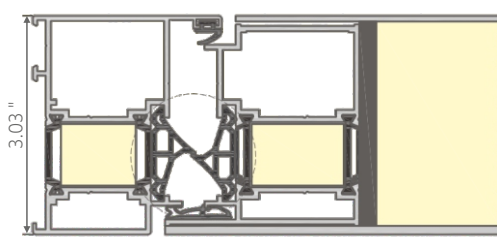
The PRESTIGE has vast design options (finishes, colors, styles) and integrates seamlessly with other Yawal USA products.

ADVANTAGES OF THE SYSTEM

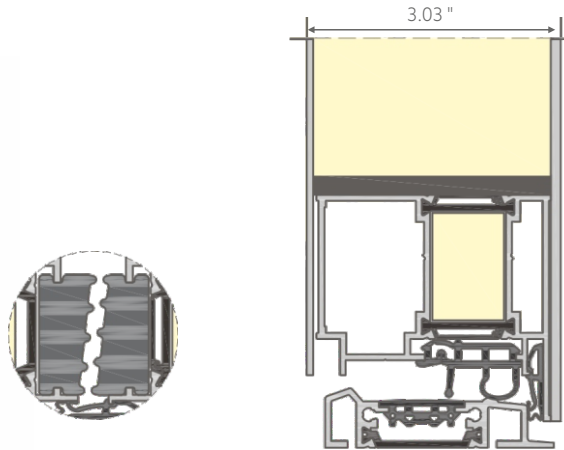
- High performance results in the areas water, air, thermal and fire resistance
- Combines seamlessly with other Yawal USA systems
- Wide variety of paint and finish options, allowing designer to meet their vision
- Easy and fast installation



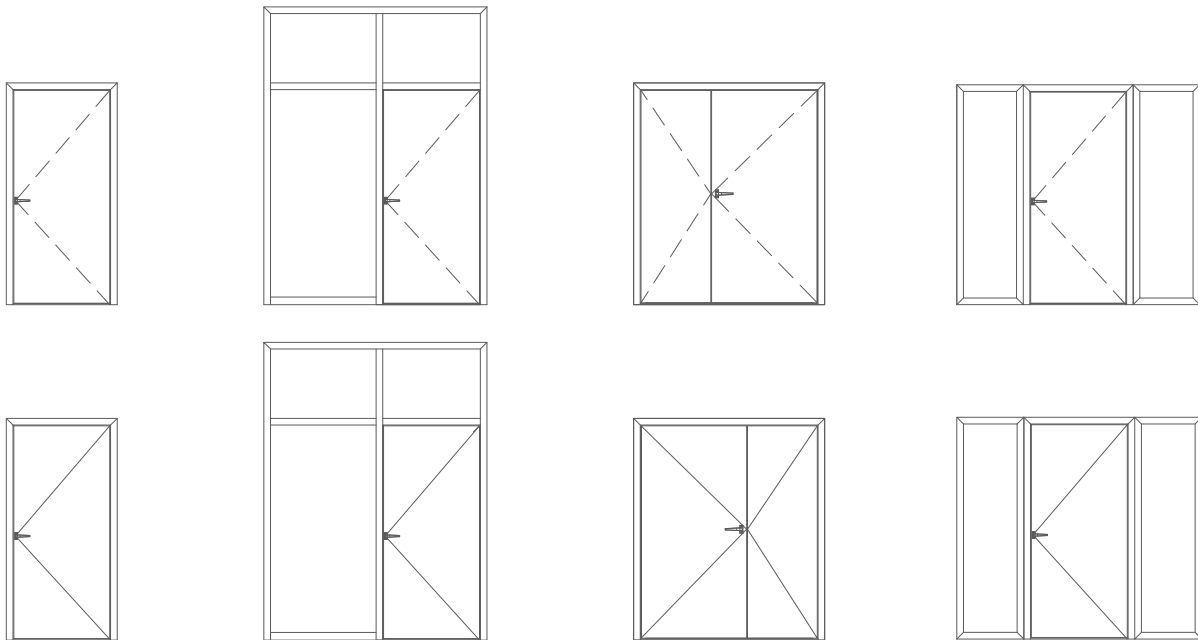
CROSS SECTION OF EXTERNAL DOOR
PANO PRESTIGE



CROSS SECTION OF DOOR PANO PRESTIGE -
THRESHOLD SOLUTION



CONFIGURATION OPTIONS OF PANO PRESTIGE SYSTEM



TECHNICAL PARAMETERS - PANO PRESTIGE

Air tightness	A3
Water tightness	7,5 psf
Designed pressure	CW 50 psf
U-Value	from 0,12 Btu/hft ² F
Forced entry resistance	RC2, RC3
Acoustic insulation	STC = 33 dB

SYSTEM CHARACTERISTICS

Door structural depth	Frame profile	3.03 " (77 mm)
	Sash profile	3.03 " (77 mm)
Pane thickness	1,18÷3,03 "	
Max. dimension of sash	height	10 ft
	width	4.5 ft

EXAMPLES OF PANEL DOOR YAWAL PRESTIGE

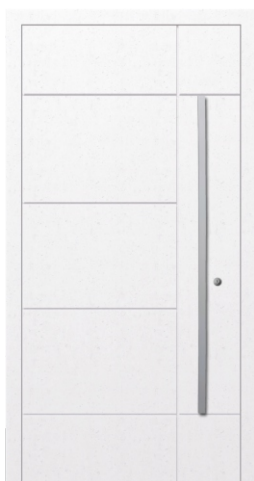
Offer of Yawal S.A. consists of 15 basic models of panel door (maximum size of panel 50 "x 98 ").

They may be customized by:

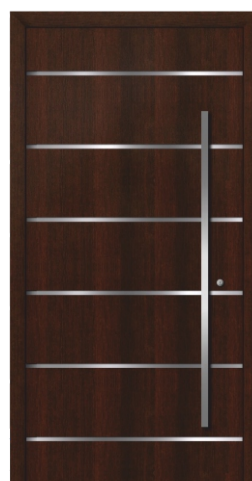
- possibility to choose the coating from RAL colors range, anodised surfaces, metallic colors, or structural effect, and traditional glazed panels, or panels imitating wood,
- properly selected fittings: hidden hinges, roller hinges, or surface hinges,
- door handles or pull handles made of stainless steel, plastics, or casted,
- all doors are equipped with internal handle made of stainless steel and external pull handle made of stainless steel,
- reach offer or sidelight and small windows,
- decorative application and millings made in panel door at the client's request. Scope of the milling is from 0.39 to 2.36 ".



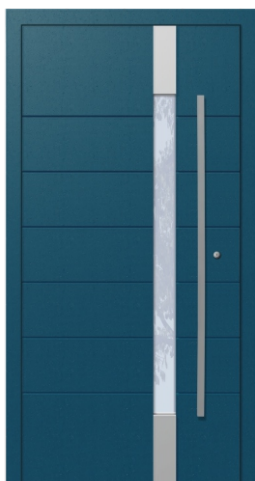
HIGIEJA



NIKE



KLIO



EUROPA



DAFNE



TALIA



PERSEFONA



KALIOPE



EOS



TEMIDA



HESTIA



HARMONIA



DEMETER



MUZA



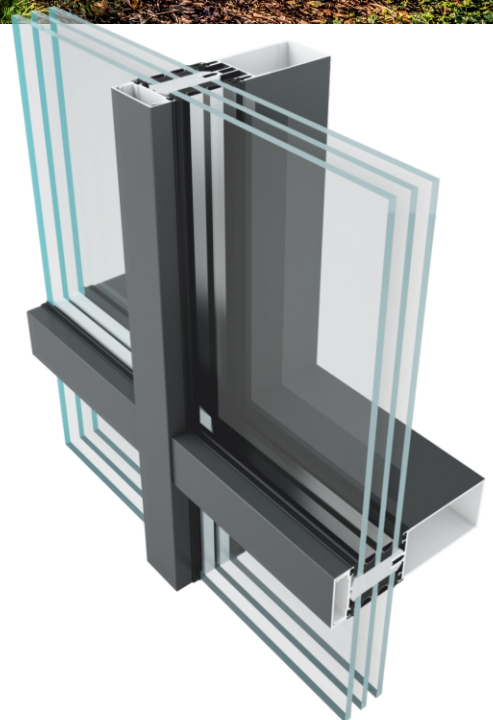
KORA



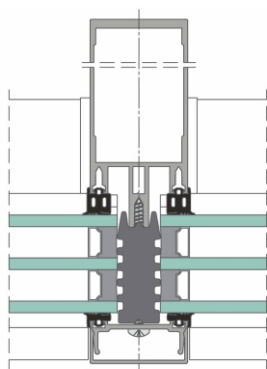
FA 50 DESIGNLINE product line boasts a unique system of foam insulation and insulating glass panes that can advance its energy efficiency output.

ADVANTAGES OF THE SYSTEM

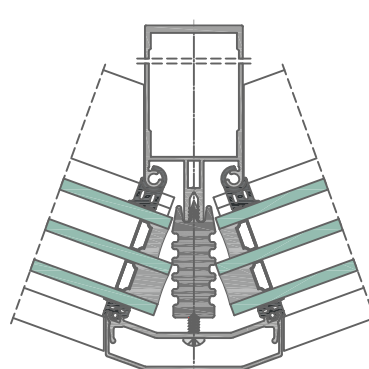
- Can be fabricated into various shapes including turns, bends, polygonal shapes and more
- Combines seamlessly with other Yawal USA systems
- High performance results in the areas water, air, thermal and fire resistance
- Wide variety of paint and finish options, allowing designer to meet their vision



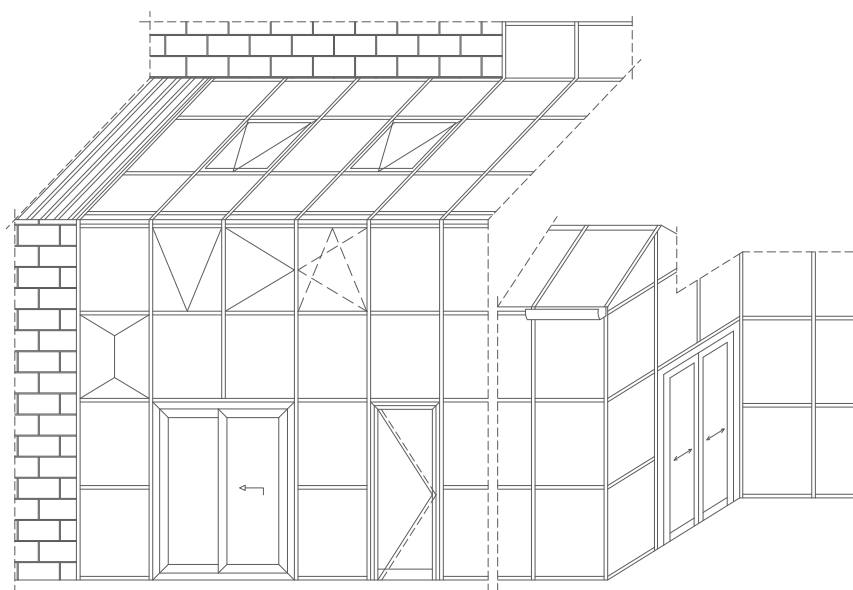
MULLION CROSS-SECTION
FA 50 DESIGNLINE



CROSS SECTION OF ANGLE STRUCTURE
FA 50 DESIGNLINE



CONFIGURATION OPTIONS OF FA 50 DESIGNLINE SYSTEM



TECHNICAL PARAMETERS - FA 50 DESIGNLINE

Air tightness	A3
Water tightness	15 psf
U-Value	from 0.11 Btu/hft ² F
Designed pressure	AW 75 psf
Acoustic insulation	STC = 53 dB
Forced entry resistance	RC2, RC3, RC4
External visible width	1.97 " (50 mm)
Internal visible width	1.97 " (50 mm)
Glazing	fixed with termination bars and masking strips
Glazing thickness	0.24÷2.44 " (6÷62 mm)
Operable panels	<ul style="list-style-type: none"> - outwards tilt / awning FA 50 VENTLINE - inwards opened windows - inwards opened windows in systems - automatic door of PANO and SCENIC systems

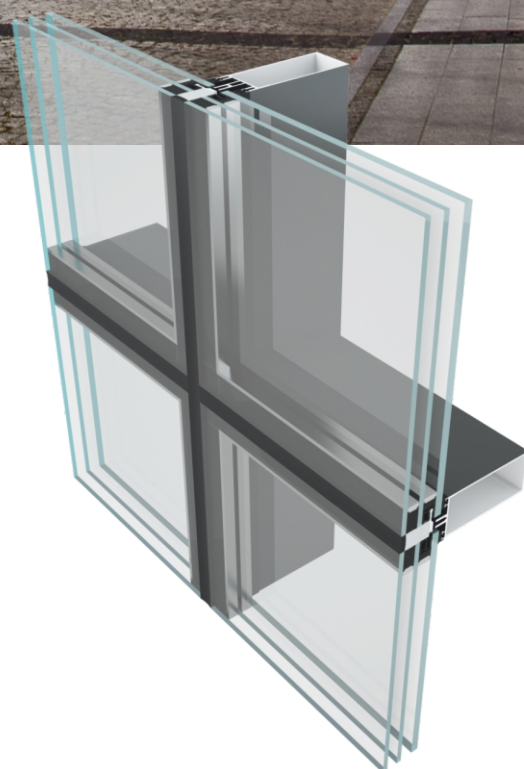


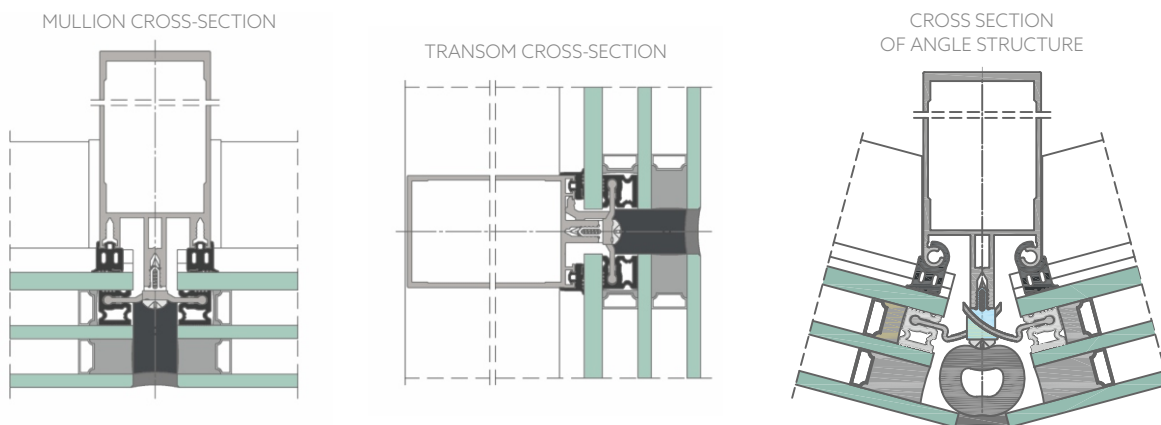
FA 50 SMOOTHLINE Facade System is your classic transom-and-mullion facade that has appearance of a structural facade.

Featuring a minimalist design, this line allows maximum natural light and is perfect for designs that demand that.

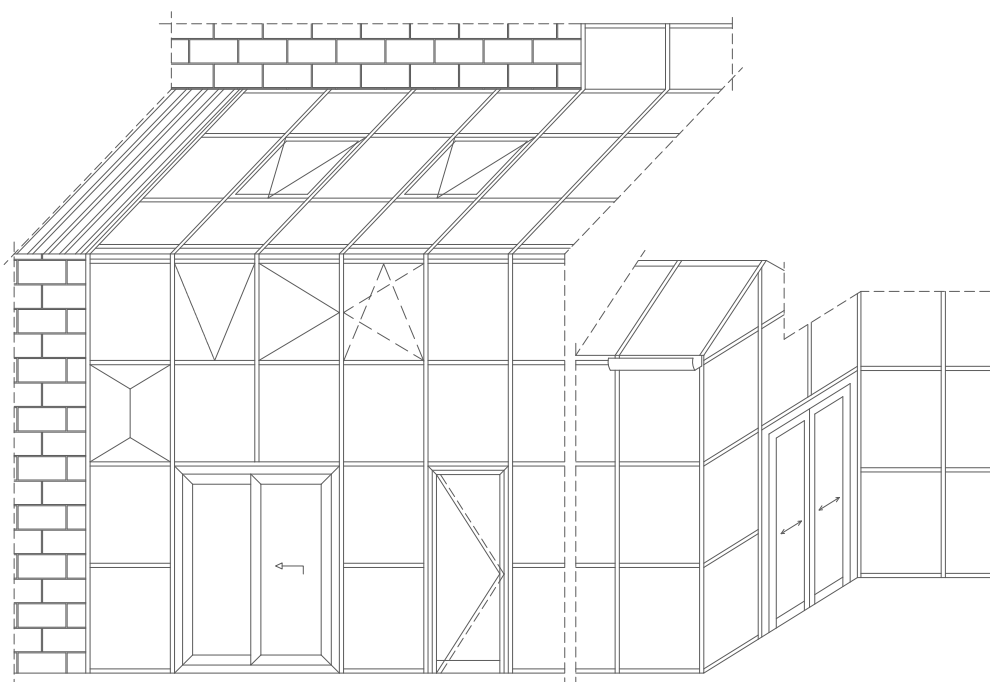
ADVANTAGES OF THE SYSTEM

- Can be fabricated into various shapes including turns, bends, polygonal shapes and more
- Options allow tilt or parallel sliding windows next to each other, for windows that are opened independently
- High performance results in the areas water, air, thermal and fire resistance
- Wide variety of paint and finish options, allowing designer to meet their vision





CONFIGURATION OPTIONS OF FA 50 SMOOTHLINE SYSTEM



TECHNICAL PARAMETERS - FA 50 SMOOTHLINE

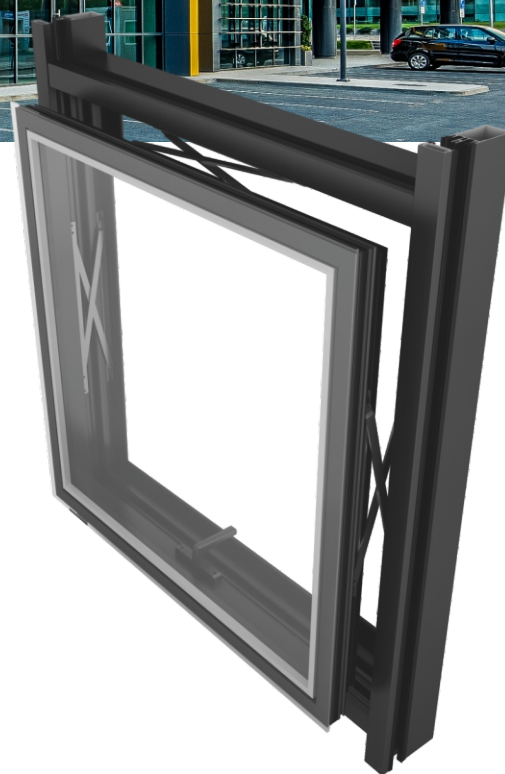
Air tightness	A3
Water tightness	15 psf
U-Value	from 0.14 Btu/hft ² F
Designed pressure	AW 75 psf
Acoustic insulation	STC = 50 dB
Forced entry resistance	RC2, RC3, RC4
External visible width	1.97 " (50 mm)
Internal visible width	1.97 " (50 mm)
Glazing	mechanical assembly using internal glass pane
Glazing thickness	0.24÷2.44 " (6÷62 mm)
Opened elements	- outwards opened tilt/sliding windows (FA 50N VENTLINE) - inwards opened windows PANO SCENIC



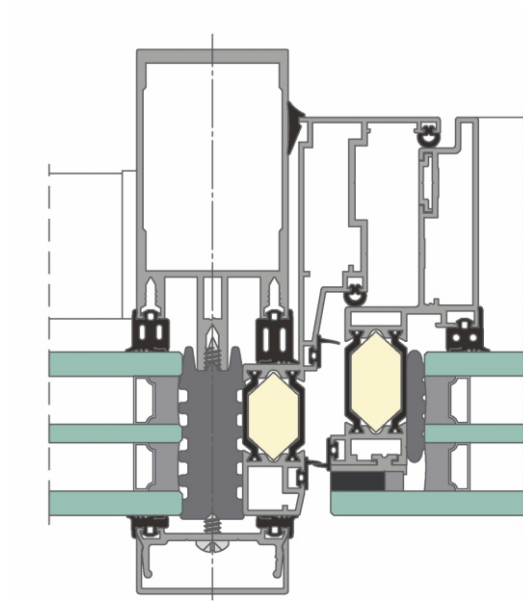
FA 50 VENTLINE is a universal structural window system that allows for installation of parallel sliding, tilt or turn windows in a facade, with mechanically or structurally assembled glazing.

ADVANTAGES OF THE SYSTEM

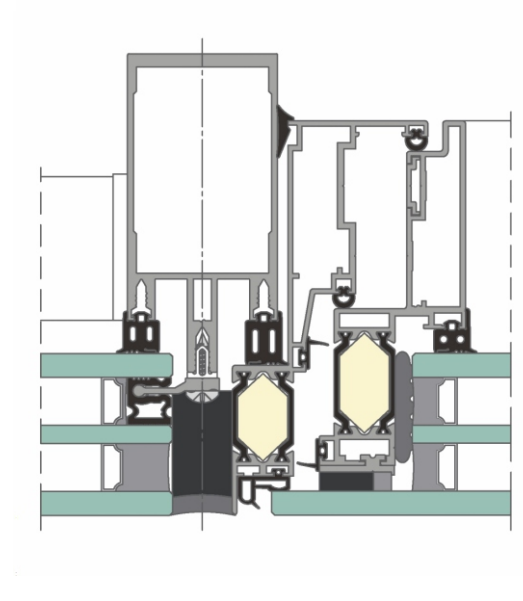
- Intelligent design that allows a clean and interrupted look
- Wide variety of paint and finish options, allowing designer to meet their vision
- Vented window option for natural air allowance
- High performance results in the areas water, air, thermal and fire resistance



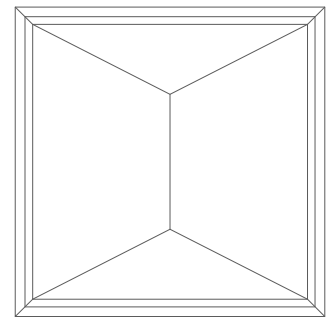
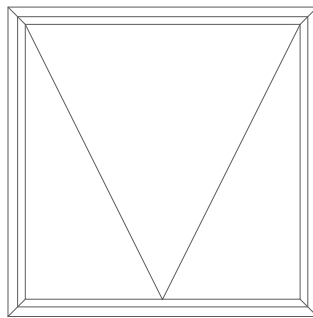
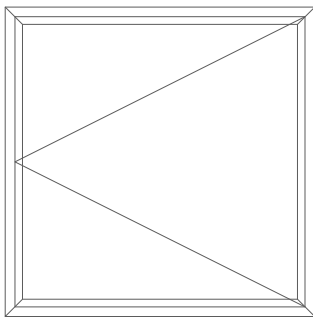
MULLION CROSS-SECTION - WINDOW FA 50 VENTLINE
IN FACADE FA 50 DESIGNLINE



MULLION CROSS-SECTION - WINDOW FA 50 VENTLINE
IN FACADE FA 50 DESIGNLINE



CONFIGURATION OPTIONS OF FA 50 VENTLINE SYSTEM



TECHNICAL PARAMETERS - FA 50 VENTLINE

Air tightness	A3
Water tightness	15 psf
U-Value	from 0.23 Btu/hft ² F
Designed pressure	AW 75 psf
Acoustic insulation	STC up to 45 dB
Glazing	mechanical or structural assembly
Glazing thickness	single-chamber 1.02÷1.26 " (26÷32 mm) double-chamber 1.81÷2.44 " (46÷62 mm)
Opened elements	tilt outwards, sliding, turn window's type
Max. dimension of windows	height: 10 ft width: 7 ft weight: 400 lbs



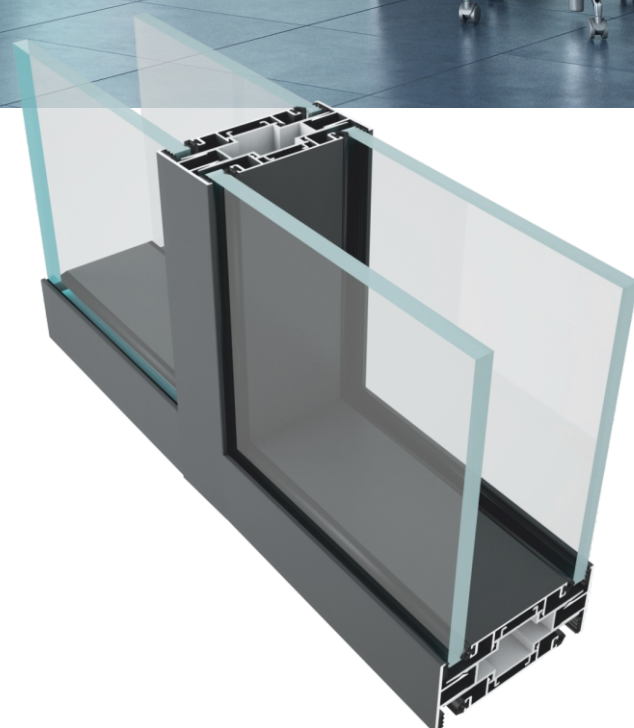
System OFFICE allows for profiles with or without thermal insulation intended for the execution of light walls and indoor partitions of high performance and aesthetic properties.

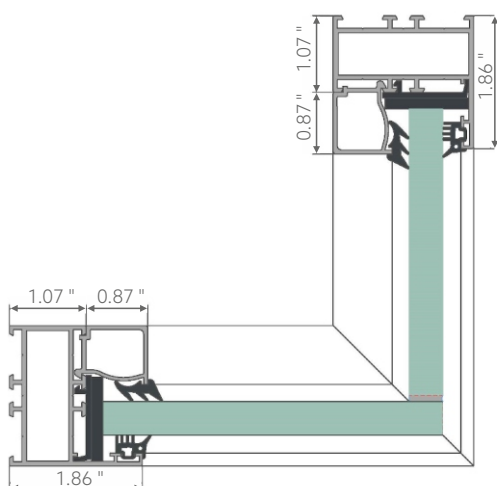
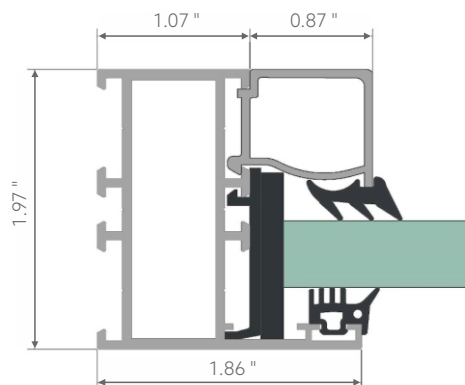
The system is perfect for the execution of permanent walls and all-glass door leaves.

ADVANTAGES OF THE SYSTEM

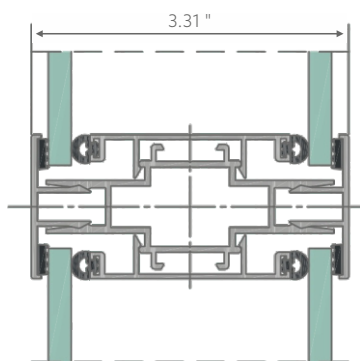
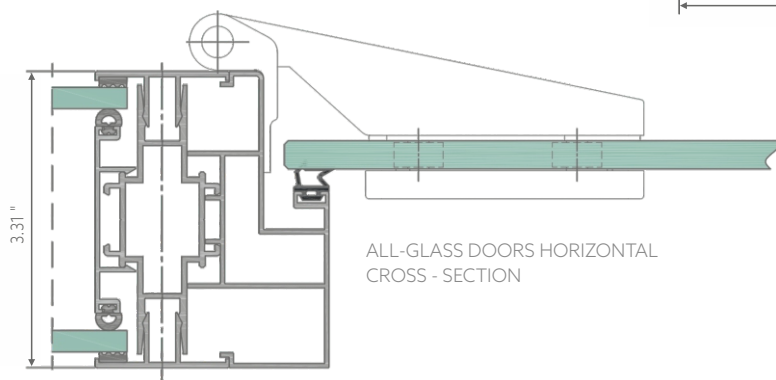
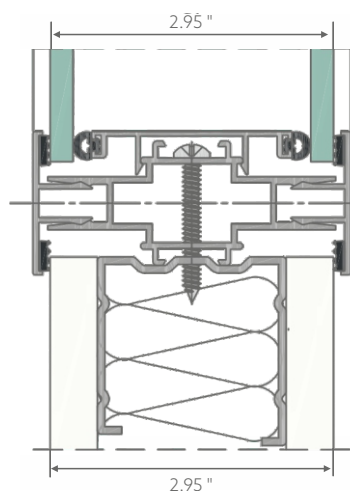
- No crosspieces which divide the glazing
- Possibility of using various contour profiles
- Maximum structure height is 10 ft
- Possibility of creating an all-glass structure

Photo: Example of system use



CROSS-SECTION THROUGH CORNER 90°
OFFICE GLASS

CROSS SECTION OF THE DOOR
FRAME GLASS


CROSS - SECTION OF MULLION AND CROSSPIECE


ASSEMBLY OF A WALL
TO A STANDARD PLASTERBOARD

ALL-GLASS DOORS HORIZONTAL
CROSS - SECTION

TECHNICAL PARAMETERS - OFFICE

Acoustic insulation	STC = 39÷48 dB
Visible width	1.50 " (38 mm)
Profile depth	3.31 " (84 mm)
Glazing thickness	0.24÷0.51 " (6÷13 mm)
Board thickness	0.47÷0.71 " (12÷18 mm)



SUN SHADES are an important attachment to architectural curtain wall, window, and storefront systems.

Yawal SUN SHADES are available with all products offered in our product lines. SUN SHADES provide protection from sun, UV, weather and more.

ADVANTAGES OF THE SYSTEM

- Automatic control available
- Fixed and movable louvers
- Complete anti-solar protection of a building

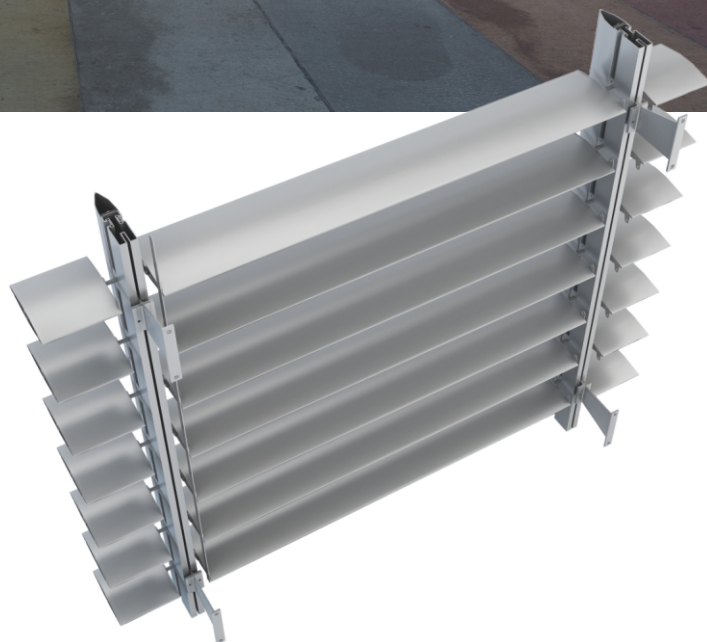
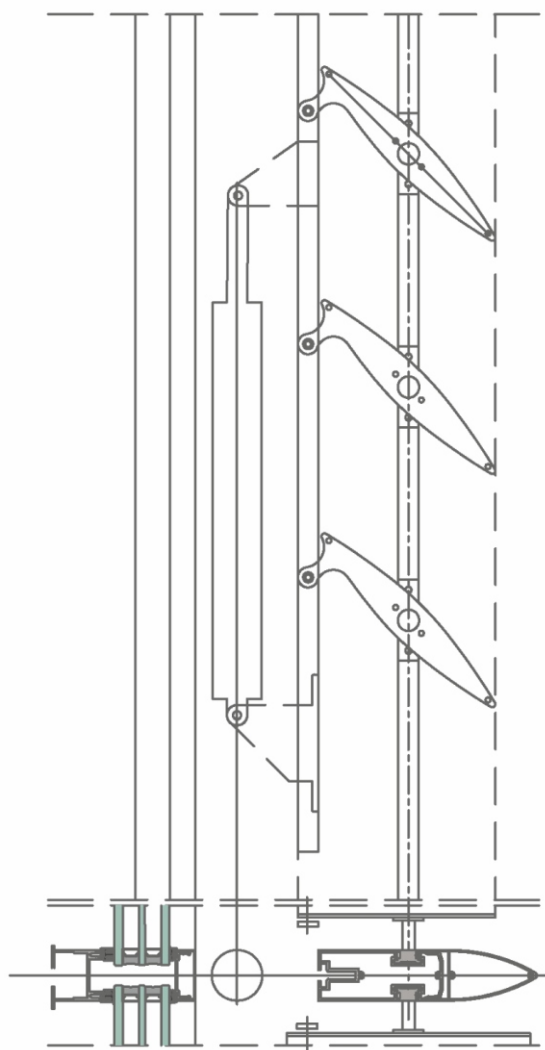
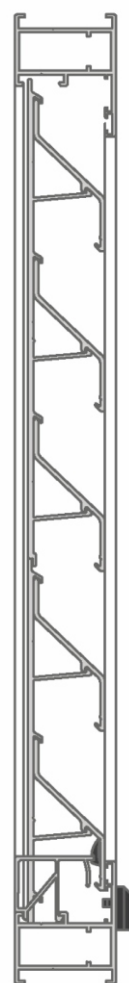


Photo: City Public Library, Sosnowiec / Design: Pracownia Projektowa AiM Arkadiusz Miśkiewicz, Katowice
Aluminium manufacturer: APS-System, Częstochowa

CROSS SECTION OF LOUVERS
YAWAL SUN SHADES - MOBILE VERSION



SIDE CROSS - SECTION OF LOUVERS



TECHNICAL PARAMETERS - YAWAL SUN SHADES

Designed pressure

50 psf

SYSTEM CHARACTERISTICS

	FIXED LOUVERS	MOVABLE LOUVERS	LOUVERS
Shape of protection	elliptic / rectangular	elliptic	"z" - shaped
Protection dimensions	3,94 ", 5,91 ", 7,87 ", 9,45 ", 11,8 " (100, 150, 200, 240, 300 mm)	3,94 ", 5,91 ", 7,87 ", 9,45 ", 11,8 " (100, 150, 200, 240, 300 mm)	1,97 ", 2,36 ", 2,60 ", 2,99 ", 3,15 ", 3,39 " (50, 60, 66, 76, 80, 86 mm)
Assembly angle	0°, 9°, 15°, 18°, 27°, 30°, 36°, 45°	variable	fixed

We offer over 200 colors from the RAL palette (color matching system used in Europe). Also, we can offer NCS pallet which is unlimited. We can also show wood pattern which has about 30 types of colors.

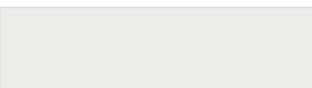









POWDER VARNISHES

All products based on Yawal systems can be made in any RAL color, in matt and satin versions. Below you can find examples of standard colors. Remaining color versions (including structural finish, metallic, pearl or concrete effect) are in the template.

			
RAL 1013	RAL 1019	RAL 3004	RAL 3005
			
RAL 5003	RAL 5014	RAL 6005	RAL 7011
			
RAL 7012	RAL 7016	RAL 7021	RAL 7024
			
RAL 7035	RAL 7039	RAL 7043	RAL 8019
			
RAL 8028	RAL 9005	RAL 9006	RAL 9007
			
RAL 9003	RAL 9010		

ANODIZING

Below you can find examples of standard colors. Remaining color versions are in the template.

			
C-0 E2	C-0 E2T	C-31 ES	C-32J ES
			
C-32C ES	C-33J ES	C-33C ES	C-34J ES
			
C-34C ES	C-35 ES		

WOOD-LIKE COLORS

Below you can find examples of standard colors. Remaining color versions are in the template.



916/1501 - MAPLE



916/1402/03 - BRIGHT OAK



916/2103 - PINE



916/2901 - IVORY



916/1406 - BIRCH-TREE



451/2103/01 - PINE



451/1406 - CHERRY



451/1403 - CHERRY



451/1402 - CHERRY



451/1401/01 - GEAN



451/1704 - MAHOGANY



682/2901 - IVORY



716/1401/01 - CHERRY



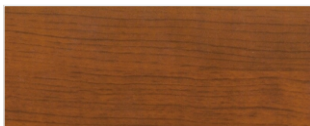
716/1402 - CHERRY



716/1501/01 - KNOT-FREE PINE



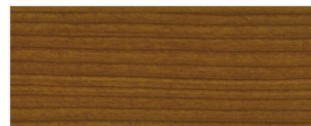
716/2103 - PINE



725/1403 - DOUGLAS FIR



733/1401 - CHERRY



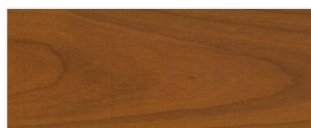
733/1402 - CHERRY



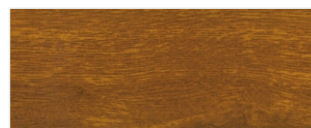
733/1403 - DARK CHERRY



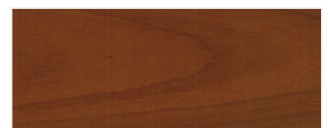
733/1829/11 - WALNUT



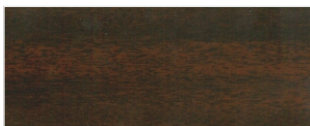
739/1406 - CHERRY



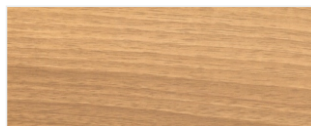
739/2301/02 - GOLDEN OAK



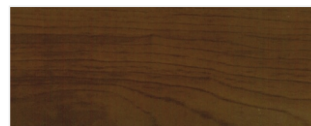
742/1406 - CHERRY



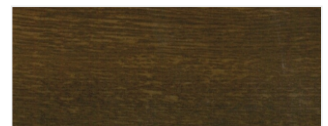
742/1704/02 - MAHOGANY



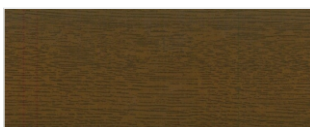
746/1829 - WINCHESTER



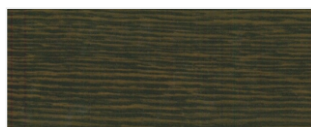
775/1403/01 - DARK CHERRY



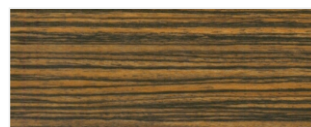
775/2301/03 - DARK WALNUT



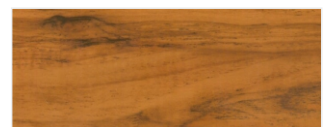
797/2305/17 - OAK



775/2516 - BOK OAK



451/2805 - ZEBRANO



451/2901 - IVORY



Yawal Inc. - 70 Leroy Street,
Tenafly, NJ 07670, USA
T. 845-304-2396

Showroom
11 West Hudson Avenue
Englewood 07631

office@yawalusa.com

www.yawalusa.com